

**7/13 California Natives**

**7/27 Acts of Kindness**

**(Give Your Garden Some Love)**

**8/10 Compost and Open Q&A**

**8/31 Lose the Lawn for Low Water Lush**

**Upcoming Workshops**



## Download Tonight's Presentation

### Folsom Water Conservation Webpage

- Rebates
- Water Wise House Calls
- Videos and Presentations
- Workshops
- Drought Info

Scroll to "Upcoming Workshops"  
for this presentation



# dropcountr

your water, right now

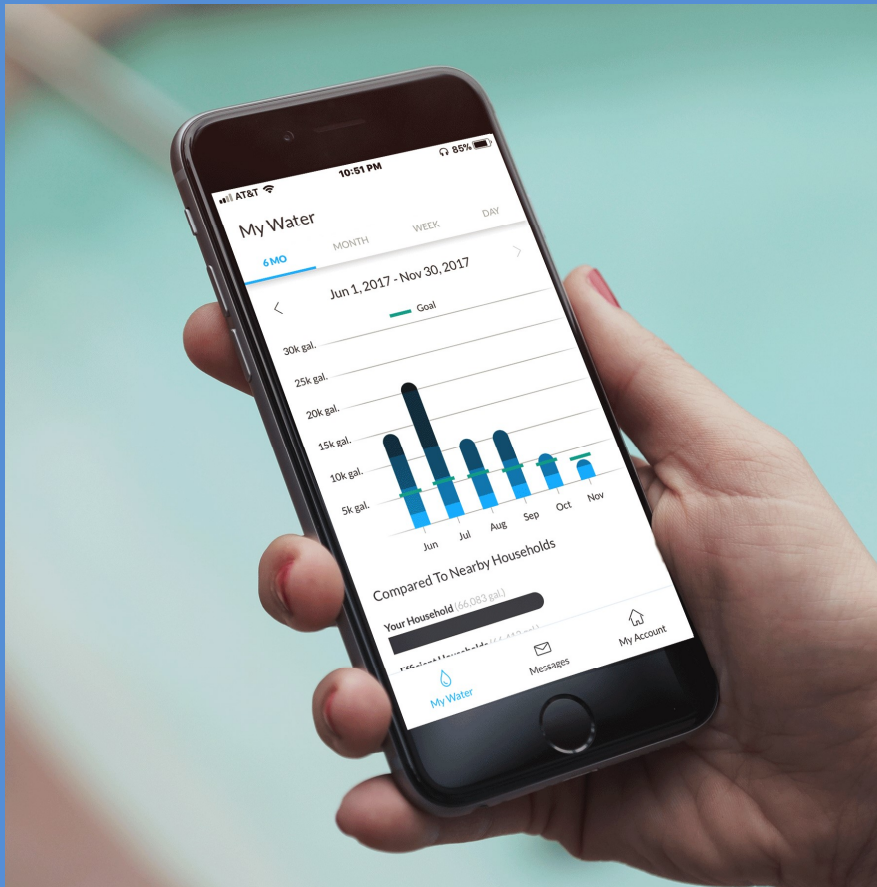

How much water do you use each month?

More than my neighbors

Less than my neighbors

Not sure? Find out.

Already have a Dropcountr account? [Log in](#)

# Direct Purchase Programs

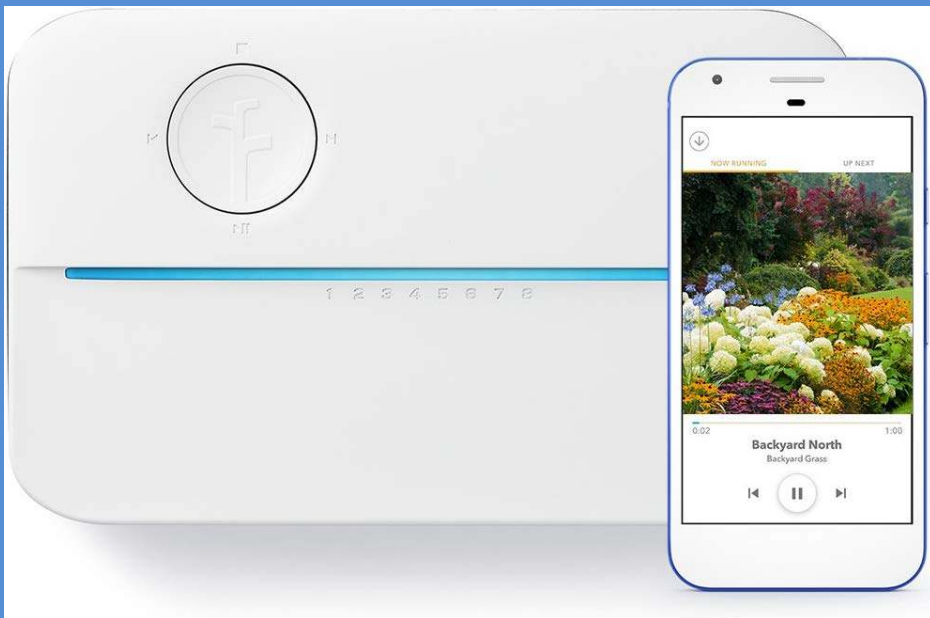

Save Money.  
Save Water.  
Save the Planet.





A Lawn Care Primer for Folsom Homeowners

All About Lawn Care





Drought



No Drought



And repeat!

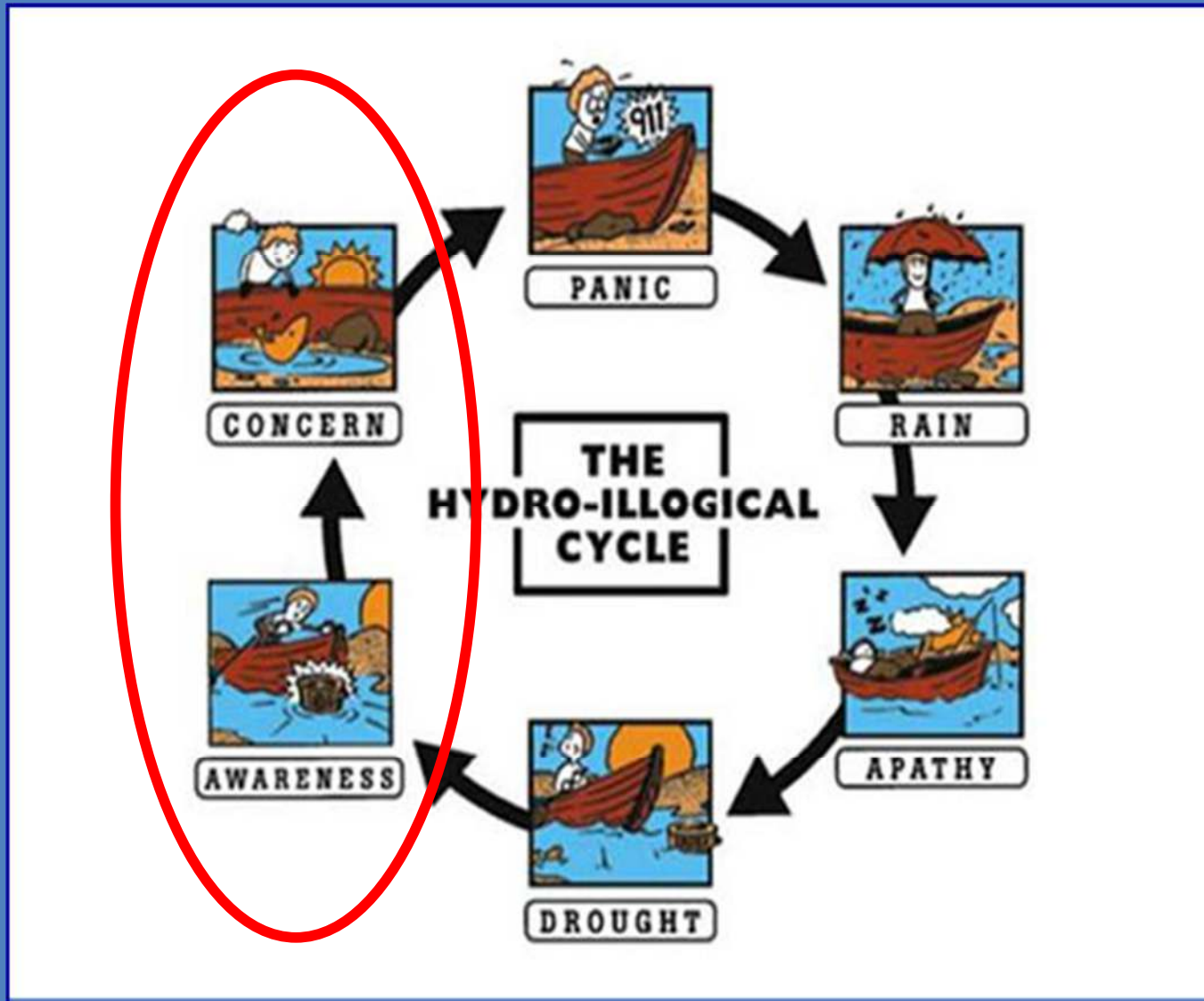

Break the Cycle

# The BIG Point

There are no simple/universal formulas for lawn care!

**BUT**

There are easy to understand concepts that make lawn care simple and efficient.

Every landscape, lawn, and irrigation system is different





# So What's the Deal with Lawns?



**A post-war symbol of prosperity**

# Think Outside the Box



# Lawns

- Why have turf?
  - Children
  - Animals
  - Play/Entertainment
  - Aesthetically pleasing
- How much do you need?
  - Just enough



# Lawns

## Pros

- Temperature reduction
- Dust control
- Consumes carbon dioxide
- Produces oxygen
- Visually pleasing

## Cons

- Thirsty
- Labor intensive
- Resource intensive
- Uses chemicals
  - Fertilizer
  - Pesticide
  - Herbicide

**And... Grass just feels good!**



# Soil is Alive!

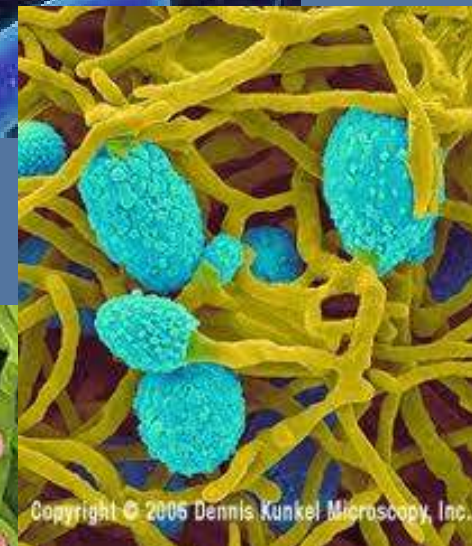
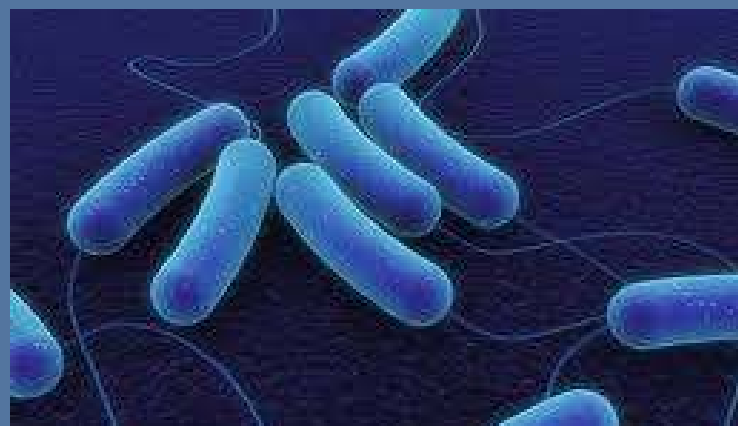
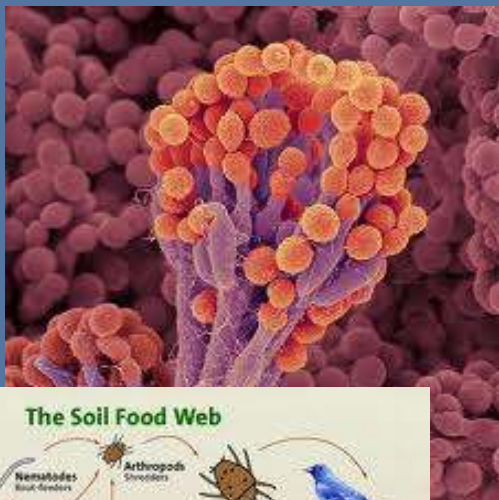

Copyright © 2005 Dennis Kunkel Microscopy, Inc.

Copyright © 2005 Dennis Kunkel Microscopy, Inc.

# The Foundation – Healthy Soil

## THE POOP LOOP

Based on information from Dr. Elaine Ingham and Soil Foodweb, Inc.  
by Alane O'Rielly Weber, Botanical Art  
(c) 2004

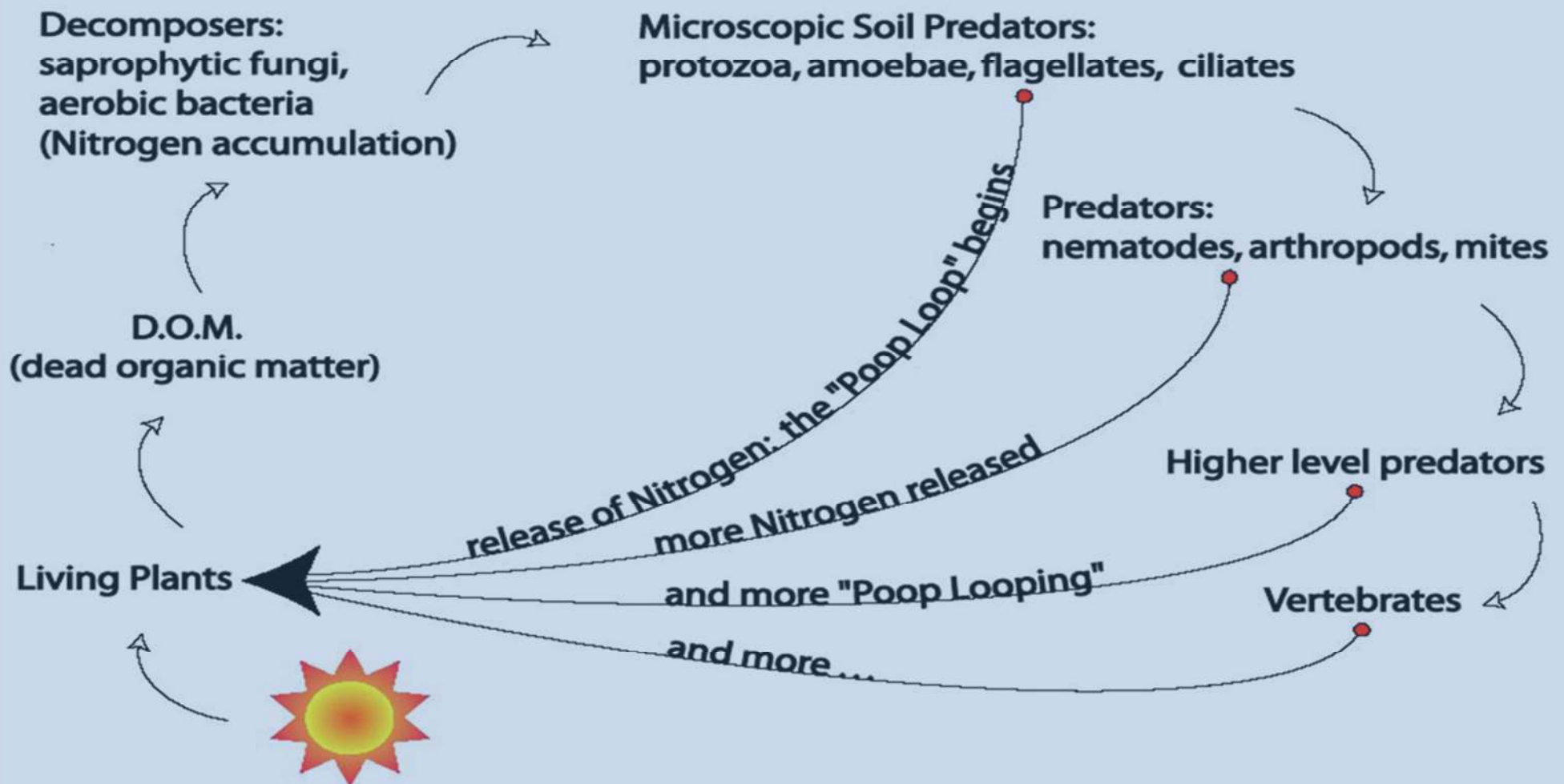

# The Moral of the Soil Story

Happy Turf Needs Happy Soil





# Lawn Maintenance

The Good



The Bad



The Ugly



**Maintenance makes the difference**

# IPM

- Integrated Pest Management
  - Why do I have a problem?
  - Is it my fault?
  - What can I change?
  - Do the least harm
  - Save the worst for last

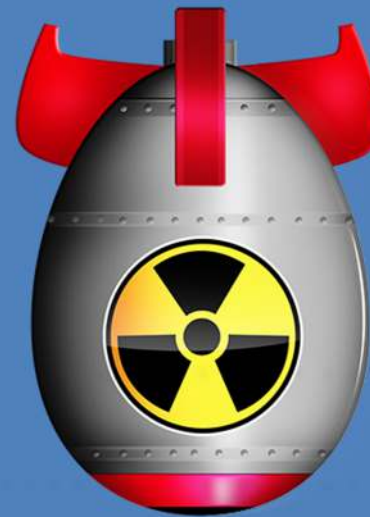

# Weeds!



# Weeds!

- Less than 10% - not a problem
- Why are the weeds there
- What can we change to discourage weeds
- Weeds can be indications of poor soil conditions
- Healthy lawns, from good practices, will shade out weeds
- IPM - Integrated Pest Management



## Mechanical



Before



Chemical

# Mowing



- Height matters
- Mow as high as you can stand it!
- Frequency, no more than necessary
- Don't remove more than 1/3 of the leaf
- Grasscycle

# Grasscycling

- Recycle lawn clippings
- A natural source of nitrogen
- Reduces the need for fertilizer
- Enhances the organic content of the soil



# Aeration

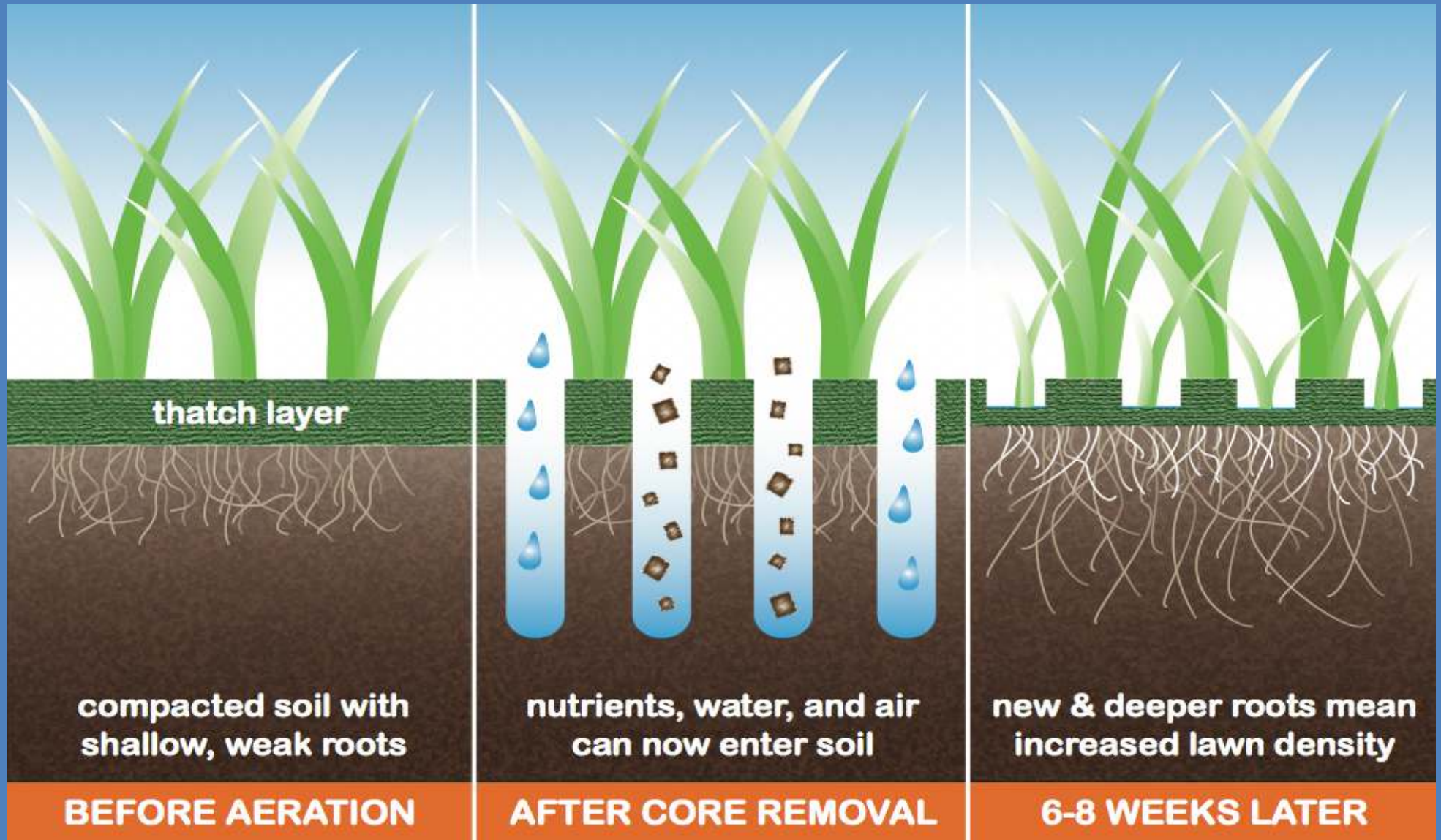

# Core Aeration

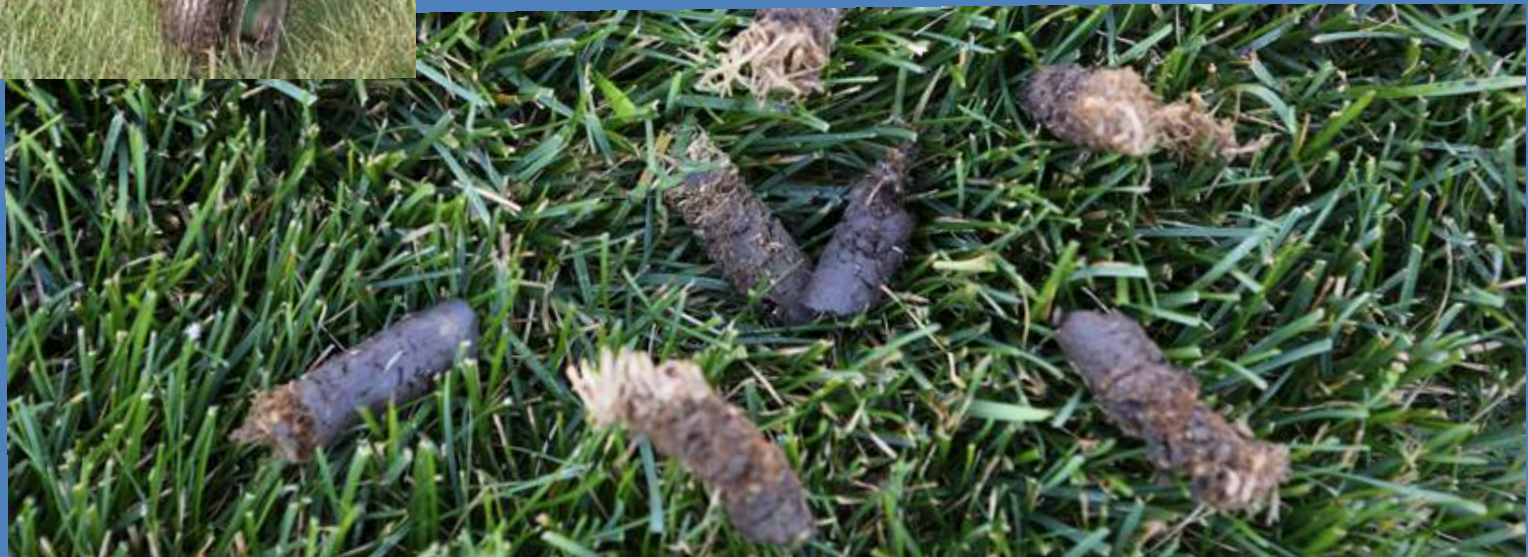



# THATCH



Why?

Too much Nitrogen and/or water

# Dethatching

## Dethatching Rake



## Dethatching Machine

## Dethatching Progeny



Hint: Don't tell Grandpa you're bored!

# Top Dressing



Compost

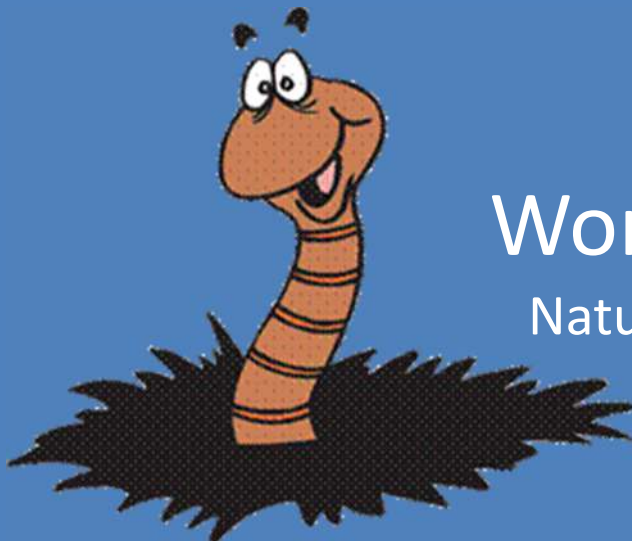

## Worm Castings

Natures Super Poop!

# Fertilizer

Read the label  
Follow Directions

N – P – K

Percentages of  
Nitrogen  
Phosphorus  
Potassium

Look for a 2-1-1 ratio  
Reconsider formulas including  
herbicides and pesticides



Fertilizers carry 3 numbers representing the following:



**NITROGEN**

greens up  
plants

**JUST THINK:**

↑ UP ↑

**NITROGEN**

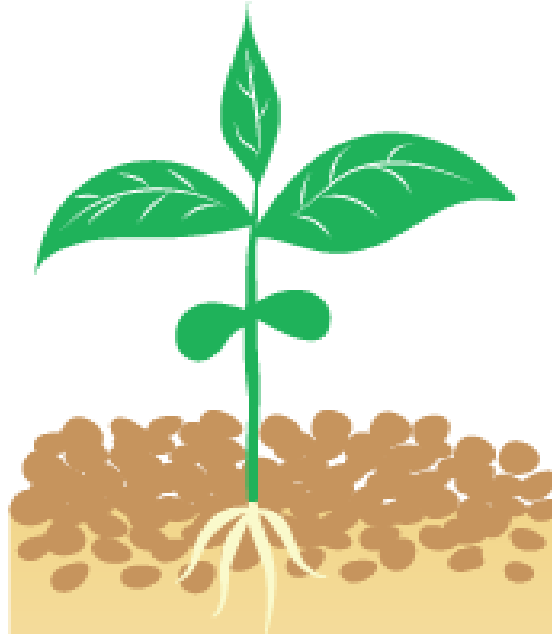

**PHOSPHORUS**

reaches down  
to the roots

↓ DOWN ↓

**PHOSPHORUS**

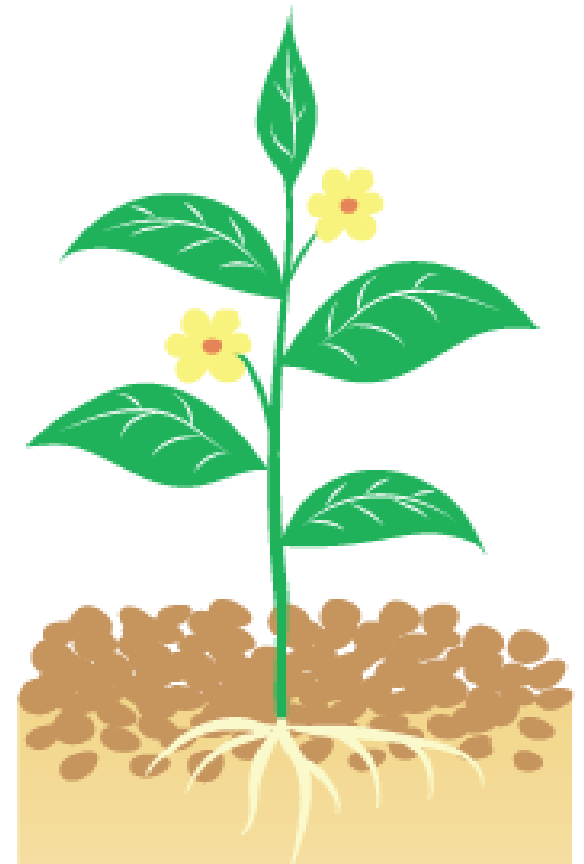

**POTASSIUM**

promotes  
all around  
wellbeing

← ALL AROUND →

**POTASSIUM**

# Fertilizer Tips

- Do's
  - Use organic
  - Read the label
  - Apply accordingly
  - Measure your lawn
  - Slow Release
  - Balanced formula
    - About 2-1-1 ratio
- Don'ts
  - Over fertilize
    - Frequency
    - Amount
  - Use water soluble
  - Use high Nitrogen
    - Ammonia Sulfate

# Fertilizer Application Rates

Need weight and area

## Square Areas

Length X Width  
Divide area into smaller squares  
then add them up

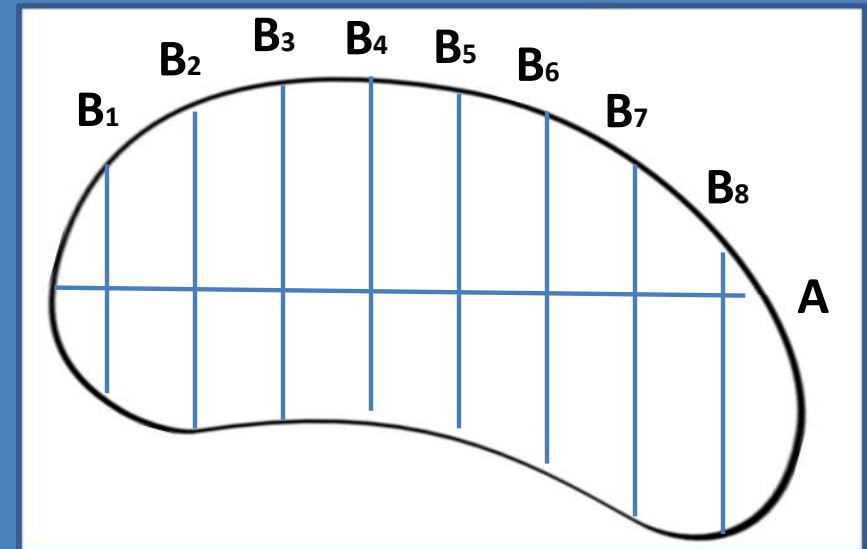
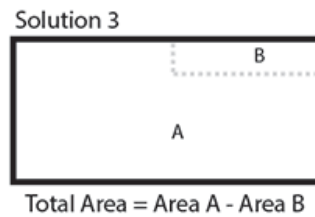
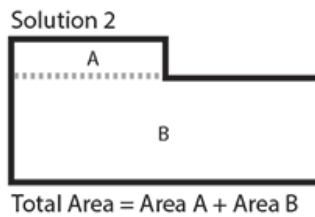
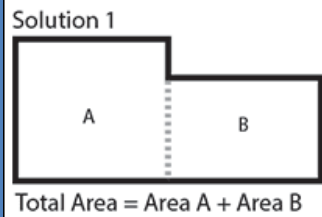
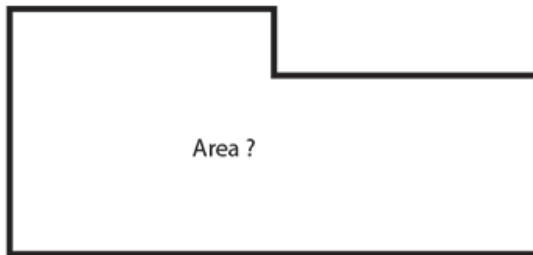

## Odd Shaped Areas

$$A \times \left( \frac{B_1 + B_2 + B_3 + B_4 + B_5 + B_6 + B_7 + B_8}{8} \right)$$

Longest Horizontal Line x Average of Perpendicular Lines

# Watering

The most common question

How long should I water?

The simple answer

Just long enough!



# Factors to Landscape Water Needs

- Plant Material
- Irrigation Equipment
- Sun Exposure
- Soil Type
- Slope



# Slopes

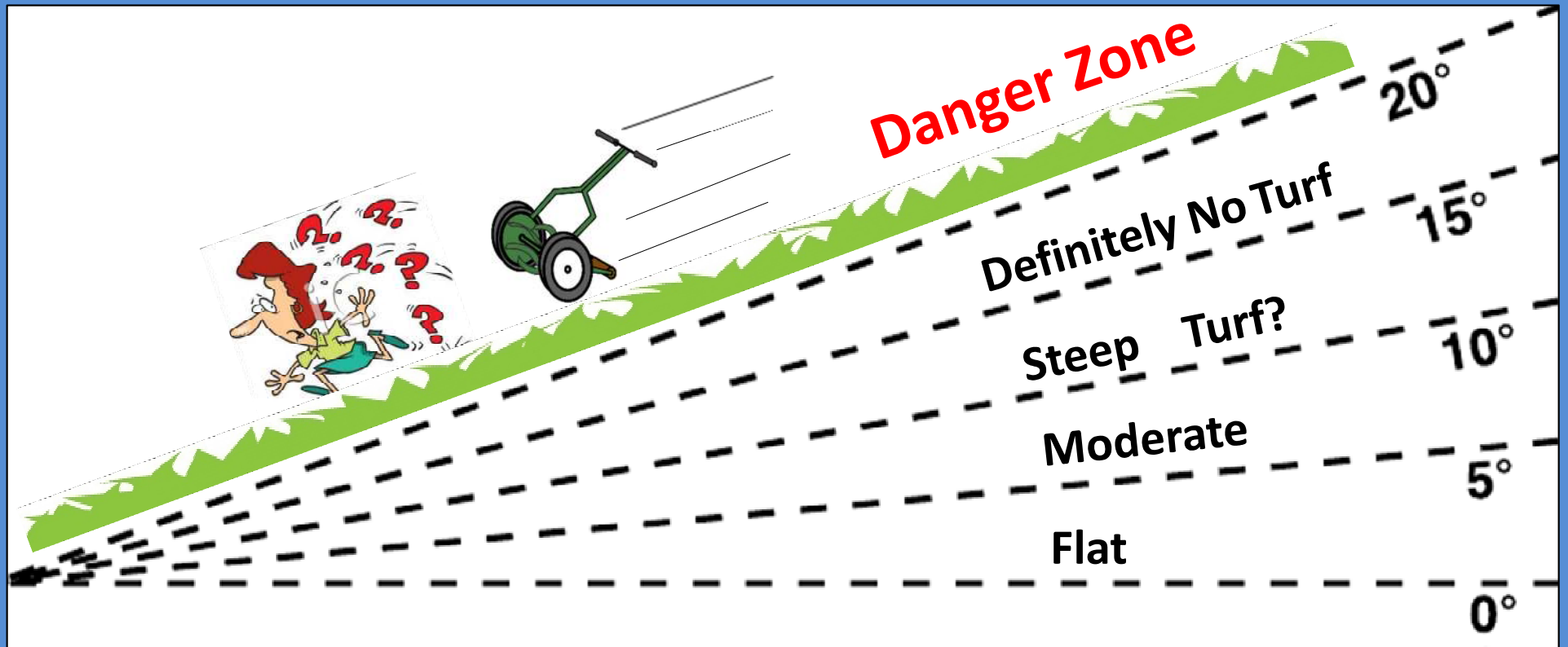

# The Better Question

How WELL do you water?

How LONG is relative  
to your irrigation  
system and landscape



# No Irrigation Since Early Nov 2016

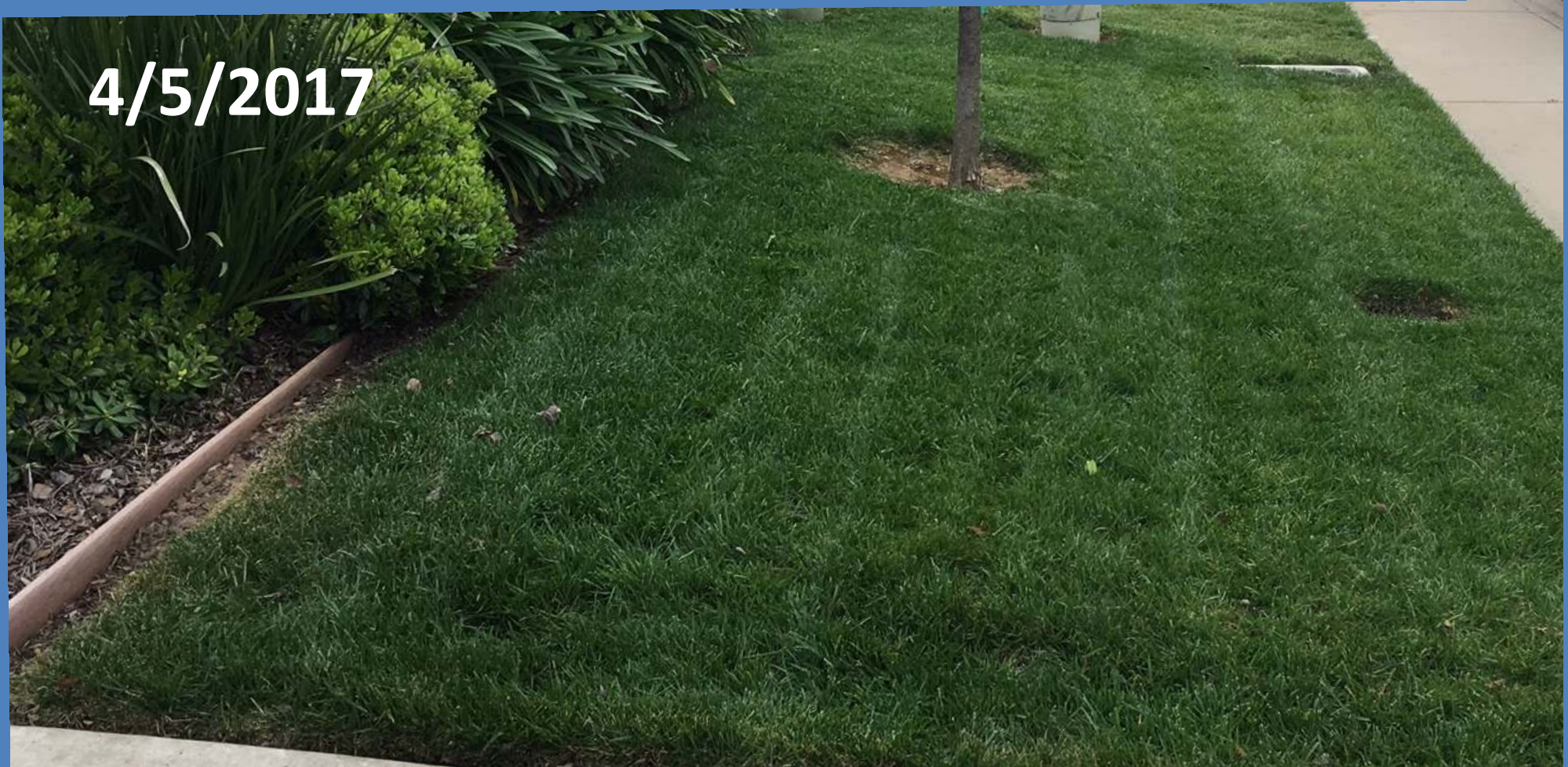

**Watered long or watered well?**

# Watering Well

- How long
  - Stop before run-off
- How often
  - Check the soil moisture
  - After the root zone dries out
  - NOT just the surface
- Early morning
  - Reduces evaporation & wind drift
- Cycle & Soak
  - Watering sessions 1 – 2 hours apart
  - Promotes deeper root growth

# Cycle and Soak

- Water short of runoff
- Allow to soak in for 1 – 2 hours
- Water again
- Repeat as necessary



# Check the Soil Moisture

How?  
Soil Probes



# Alternatives to Traditional Turf

## Native Mow Free





# Alternatives to Traditional Turf

## UC Verde Buffalograss



**UC Verde Buffalograss**  
A Grass that Drinks Responsibly

# Alternatives to Traditional Turf



Kurapia

*Lipia nodiflora*



# Alternatives to Traditional Turf

Carex Pansa

Pacific Dune Sedge



# Alternatives to Traditional Turf

## Agrostis Pallens

Native Bentgrass



# QUESTIONS ?

