

Download Tonight's Presentation

Folsom Water Conservation Webpage

- Rebates
- Water Wise House Calls
- Videos and Presentations
- Workshops
- Drought Info

Scroll to "Upcoming Workshops" for presentations





Acts of Kindness -- Give Your Garden Some Love



Cheryl Buckwalter
landscapeliaisons
@gmail.com



CLIA, QWEL,
ReScape
Landscape Consultant,
Designer, Educator



All Rights Reserved



Acts of Kindness



- Nurture your soil
- Embrace rainwater as a resource
- Respect trees & plants
- Treat water as the precious resource it is
- Care for garden life
- Resources

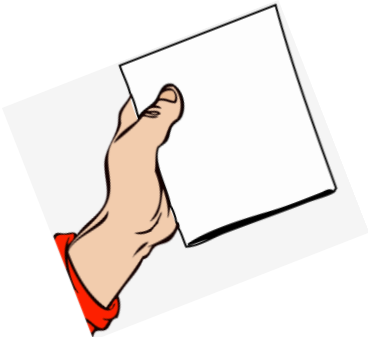



Balancing Act

These are tough times...

- For our gardens & all its creatures
- It's not a matter of *IF* but *WHEN*
 - Drought conditions
 - Water shortages
 - Extreme temperatures
 - Fires

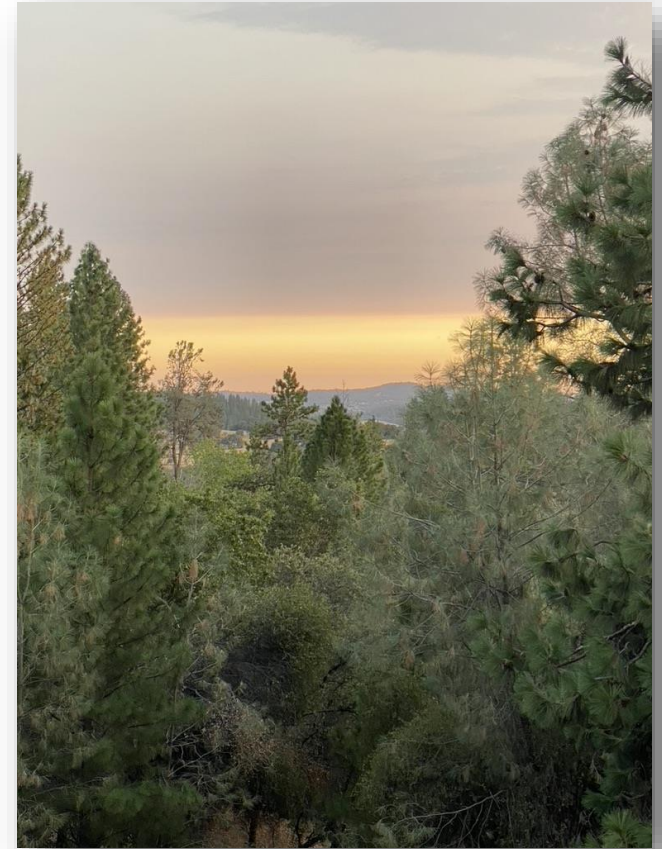



NATURAL WATER CYCLE

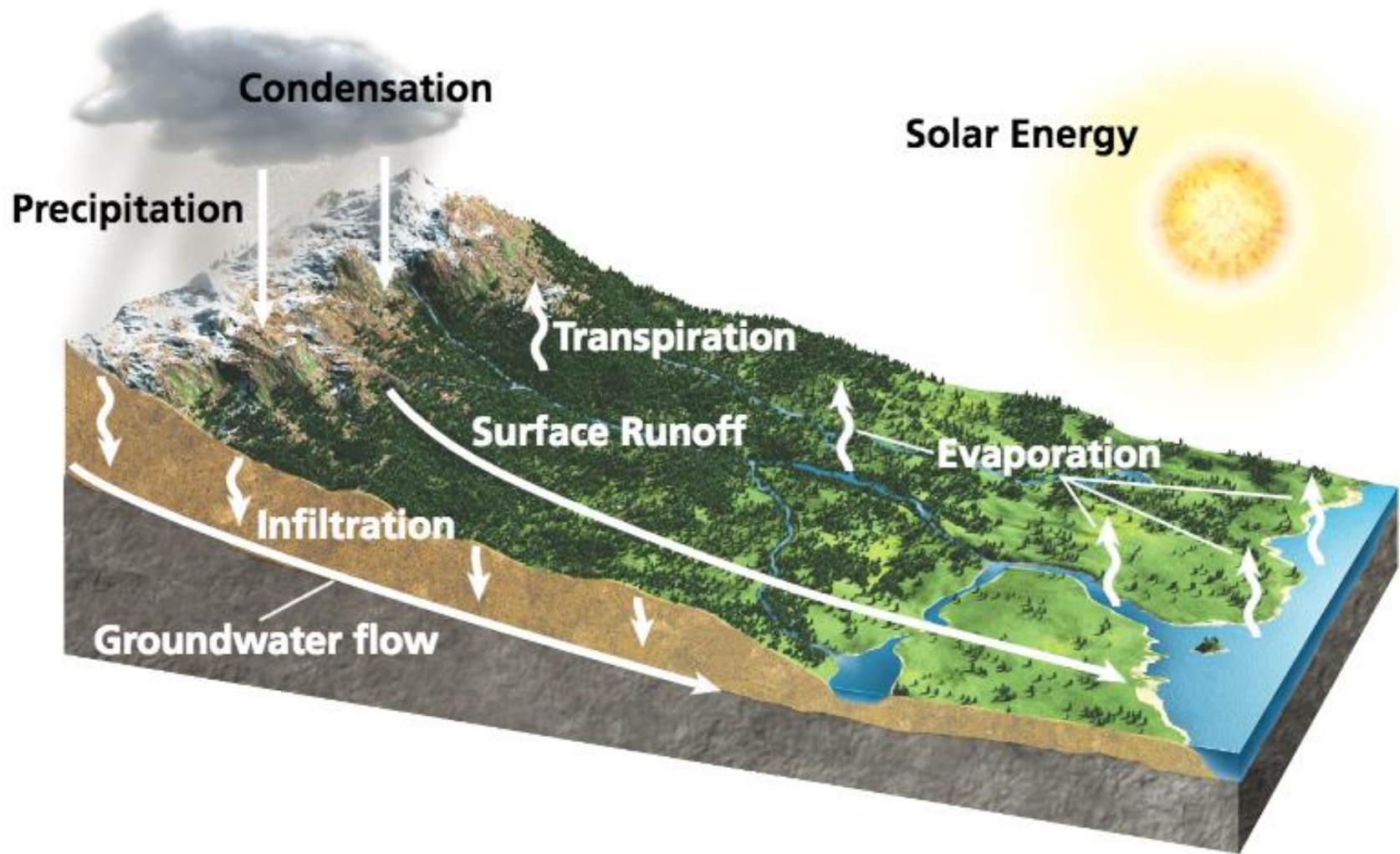

Credit: "Environmental Literacy Teacher Guide Series, Earth's Freshwater"
National Geographic

URBAN WATER CYCLE

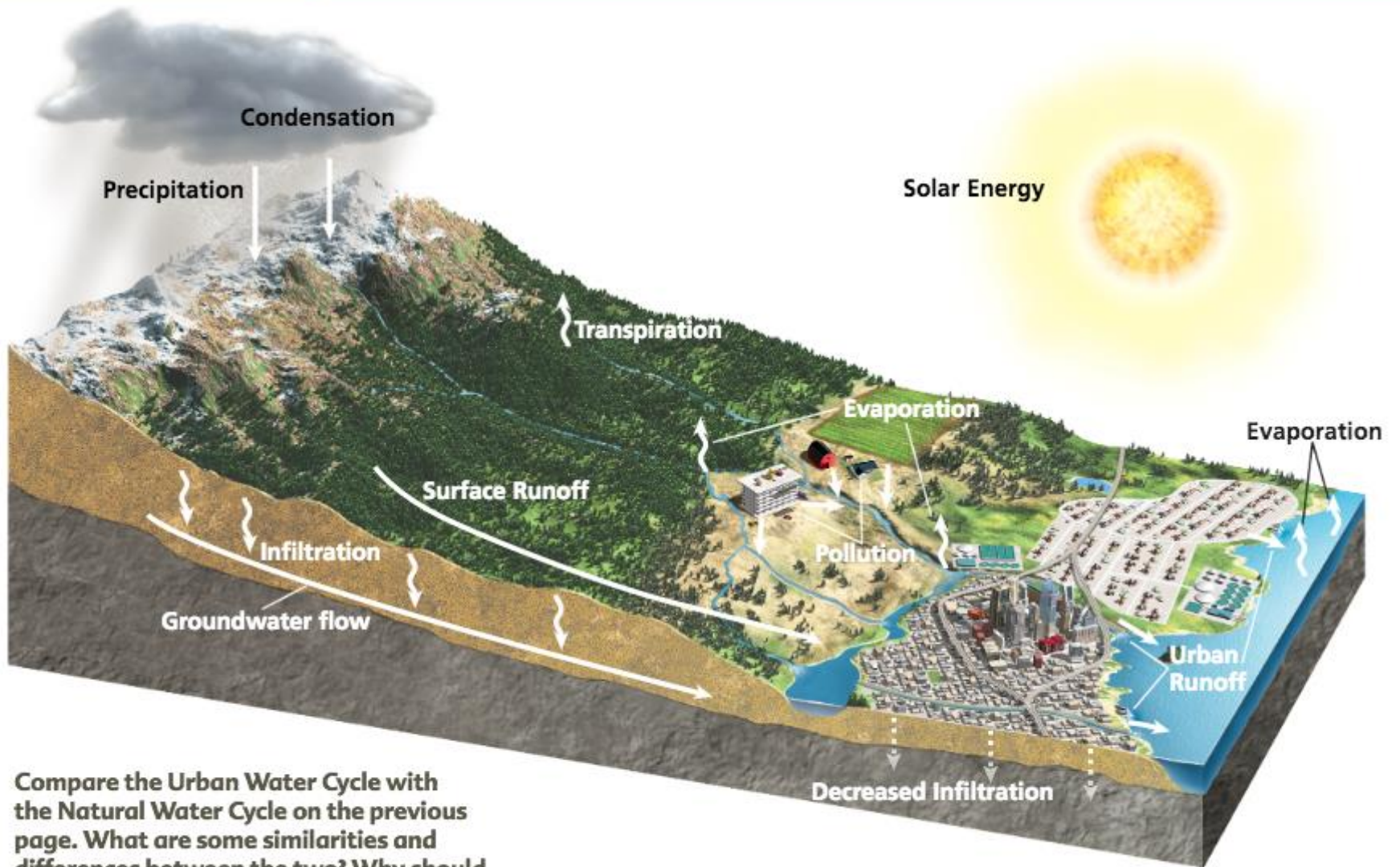

Compare the Urban Water Cycle with the Natural Water Cycle on the previous page. What are some similarities and differences between the two? Why should students be familiar with both?



Waste vs. Abundance



Dehydrated Site

- Rain & irrigation runoff drain off property & into storm drains
- Contaminated water into waterways
- Erosion depletes soil fertility

Credit: Brad Lancaster

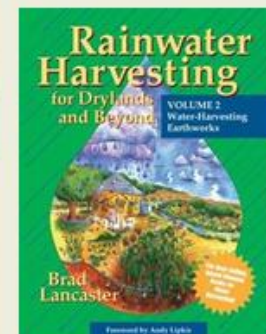
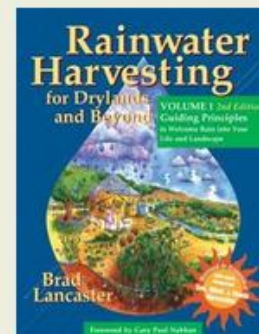



Waste vs. Abundance



Hydrated Site

- Rain & irrigation runoff soak into soil
- Soil cleanses pollutants
- Your home & landscape are a “mini” watershed

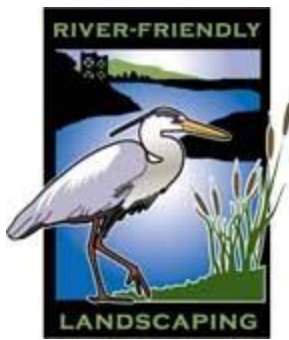

Let's Start with Soil

unlock the
SECRETS
IN THE
SOIL



Healthy, fully functioning soil is balanced to provide an environment that sustains & nourishes plants, soil microbes, & beneficial insects

-- U.S. Department of Agriculture

**“There can be no life without soil
and no soil without life;
they have evolved together.”**

Charles E. Kellogg

(1902-1980)

soil scientist





How to Create Resilient Soil? Compost!



- Slowly releases nutrients to feed & support soil organisms
- Spread 1" of compost around base of plants
- Moisten & cover with mulch
- Over time, soil becomes like a nutrient-rich sponge



What *NOT* To Do to Soil

DO NOT

- Remove organic matter, leave grass clippings & leaves
- Apply salt-based, synthetic fertilizers
- Apply pesticides
- Cultivate or till

WHY

- Kills or damages beneficial soil organisms & biological network
- Compacts soil, reduces space for movement of air (oxygen) & water



Know Your Soil Type

- A mix of sand, silt, & clay
- How to determine?
 - Soil probe
 - Jar test
 - Soil analysis by a lab





Soil Texture Combinations

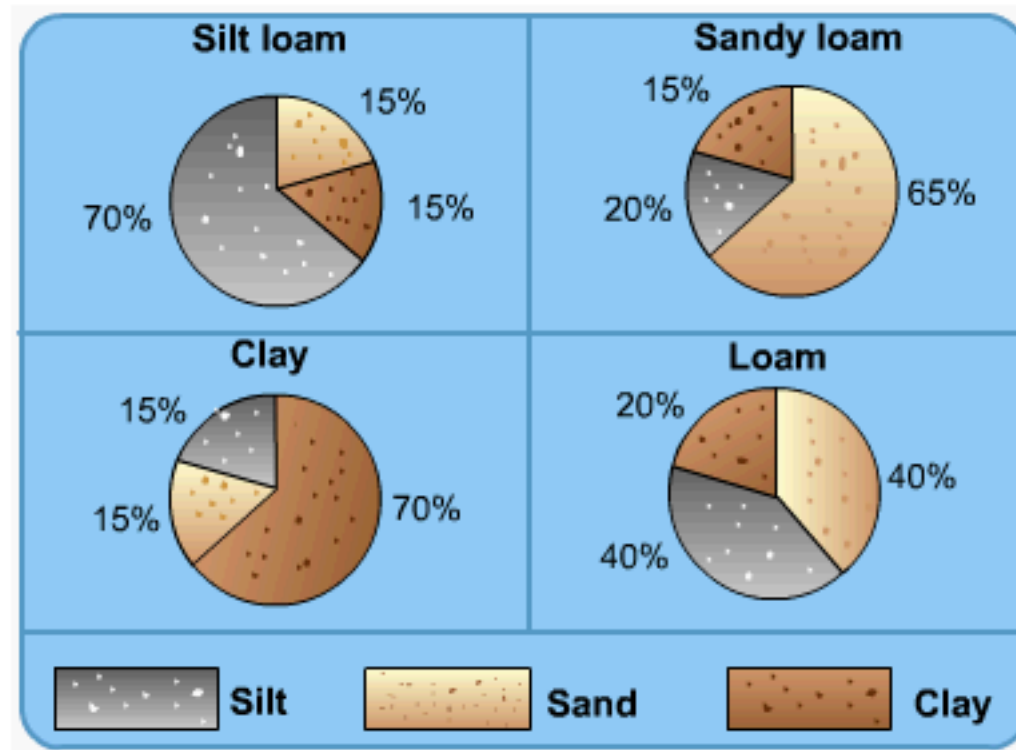

If your jar test is **20% clay, 40% Silt, 40% sand = Loam**,
you have the perfect combination.



Shaping the Soil Creek Beds

Slow, Spread, & Sink

- Rainwater *IS* a resource
- Keep it in your landscape
- Create areas with shallow depressions & swales
- Use plants that tolerate both wet & dry conditions
- Include include drip irrigation
- Remove leaf build up

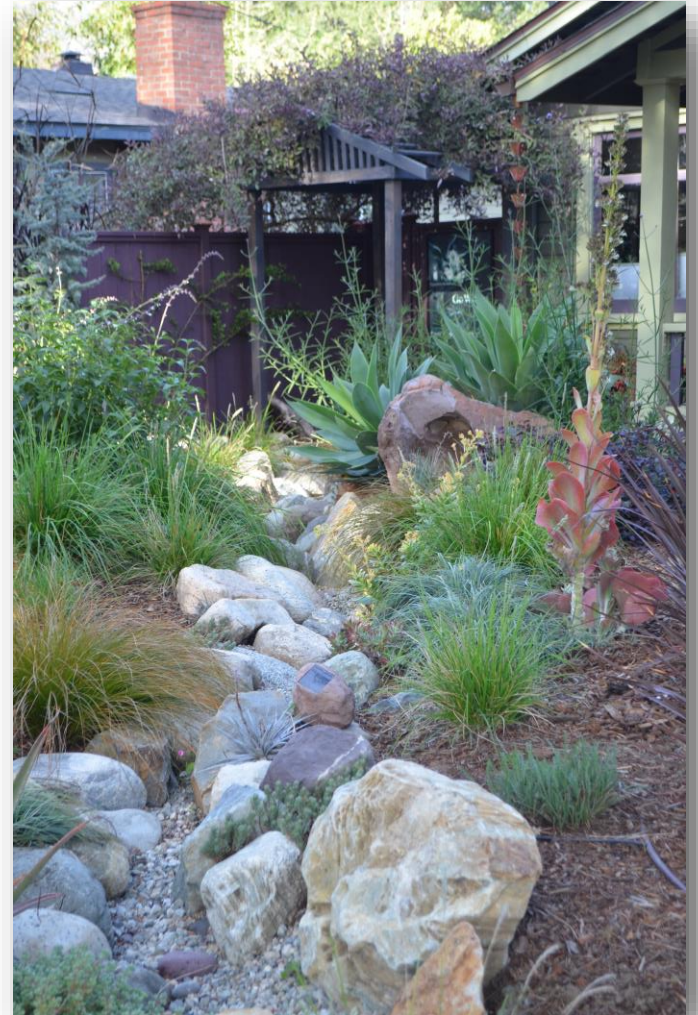



Shape the Soil Rain Gardens

- Properly designed & constructed, rain gardens drain rapidly
- Water is present for only 1 to 3 days
- Water is not “standing” (no mosquitoes)



Soleil Tranquilli
Tranquill Gardens



1” of rain from a 1,000 sq. ft. roof yields
623 gallons of fresh water
Source: U.S. Geological Survey



Soleil Tranquilli's Rain Garden



January



March



Capture & Use Rainwater as a Resource

Swales, Contours, & Berms
Garden on Eden Makeover



Before:
With lawn, used
over 110,000
gallons of water
per year

3,683 Sq. Ft.

Swales, Contours, & Berms





Swales, Contours, & Berms

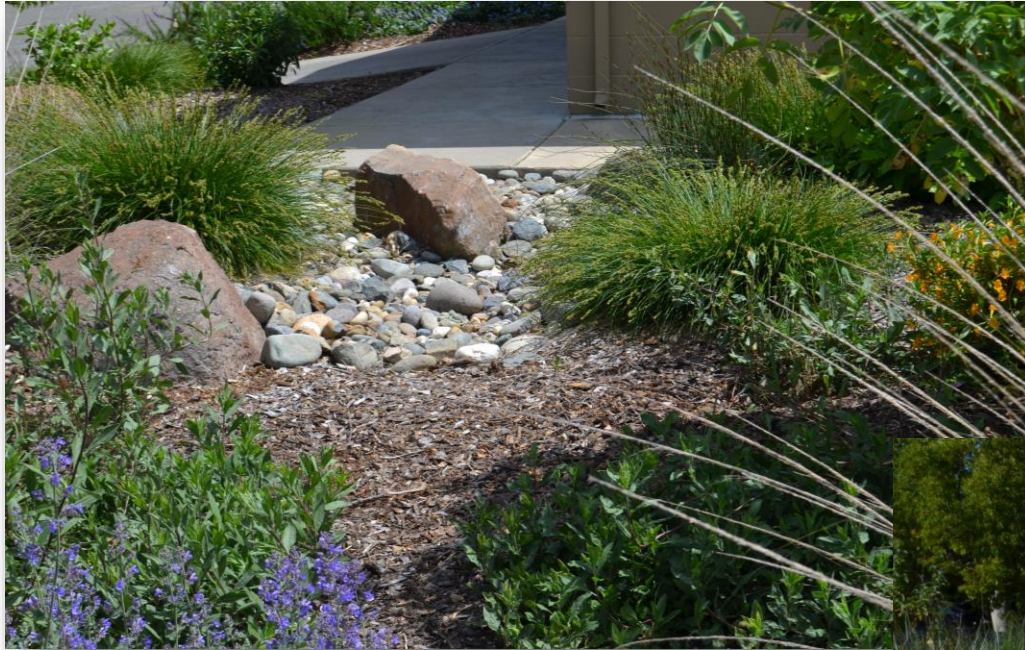

After:
Uses *less than*
25,000 gallons of
water per year





Sink Water with Materials

Decomposed
Granite
(D.G.) path



Flagstone with gravel joints



Concrete
pavers & gravel

Steps of natural
stone, gravel path



Store It Rain Barrels





Store It Cisterns





WOW!



Photo courtesy San Francisco Water, Power, Sewer



City of Sacramento
Department of Utilities



Our Shade Tree Canopy!





Plants

Select Plants Based on...

- Climate & conditions
 - Sacramento region & Central Valley
 - *Sunset Zones 7, 8, 9, 14*
 - Sun/shade, Wind, Microclimates
- Tolerance of weather extremes





Low-Water Use & Drought-Tolerant – *Not Equal*

Drought Tolerant - **Once established**

- Survive on seasonal rainfall
- Infrequent watering, or
- Repeated periods of dry conditions & recover from repeated wilting

Low Water-Use Plants:

- A constant classification
- Plants require less supplemental water than others





Characteristics of Drought-Tolerant & Many Low-Water Use Plants



Stachys byzantina
Lamb's Ear



Rosmarinus officinalis
Rosemary



Salvia apiana
California White Sage

Leaves - Retain moisture, color reduces sun exposure, "hairs", waxy surface, leathery, tiny, thick, leaf orientation

Roots – Deep taproot, fibrous



Select Plants Based on...

California Poppy
Eschscholzia californica



- Plant's water & sun requirements
- Soil type/texture (mixture of sand, silt, & clay)
- Life cycle



Chaste Tree
Vitex agnus-castus



Select the Right Plants

- Use diverse plant palette
 - California natives, &
 - Plants adapted to local climate & conditions
- Provide year-round food source, shelter, water to pollinators
- Disease resistant
 - Eliminate use of pesticides
- Resilient to extreme conditions

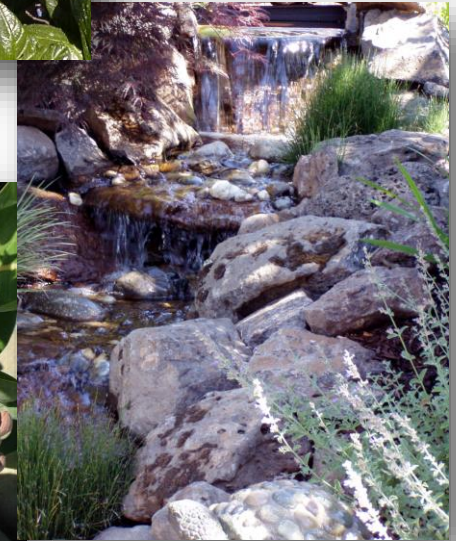
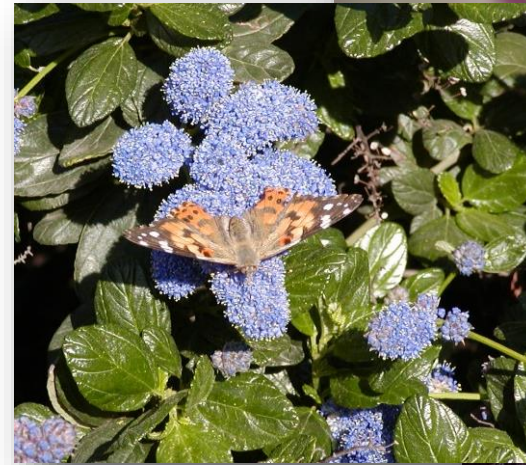



Select California Natives



Lewis Mock Orange
Philadelphus lewisii

Why?

- Preserve & support habitat
- In harmony with natural plant communities
- Restore wildlife corridors
- Increase diversity unique to location
- Lower maintenance
 - If correctly designed & installed
- Can require 60% to 90% less water
- Year-round interest
 - Use 60-70% **evergreen** plants



Select California Natives



Bringing Back the Natives
Garden Tour

Misconceptions

- Native plants look “dead” much of the year
- Fire prone
- Difficult to grow & maintain
- Native gardens have one style = messy, unkept
- All natives are “low water-use plants” – **NOT** so

Embrace a New Aesthetic



Fire-Resilience Plant Selection

- Avoid plants that contain oils, resins, and waxes
 - Examples: Junipers, Eucalyptus
- Select plants with high moisture content, low growing, stems & leaves are not oily or waxy
- Avoid “plant lists”, they’re an aide
- “Lean, clean, & green”
 - No plant is “fire proof”
 - Keep hydrated
 - No dead wood or dry plant material
 - Spaced properly
- Hydration is key



Plan for Fire

A screenshot of the CAL FIRE website. The header features the CAL FIRE logo, the text 'WILDFIRE IS COMING... ARE YOU READY?', and social media icons. Below the header is a navigation bar with links: HOME, PREPARE FOR WILDFIRE, PREVENT WILDFIRE, BARK BEETLES & DEAD TREES, SPANISH, MORE. A secondary navigation bar includes: GET READY, GET SET, GO! EVACUATION GUIDE, READY, SET, GO! CAMPAIGN. The main content area has a large banner with the text 'PREPARE FOR WILDFIRE' over a colorful illustration of a forest. Below the banner, there are sections for 'PREPARE FOR WILDFIRE' (with sub-links: GET READY, Defensible Space, Hardening Your Home, Fire-Safe Landscaping) and 'GET SET'. A central section titled 'MAINTAIN DEFENSIBLE SPACE' includes the text 'USE THE CAL FIRE APP TO GET STARTED' and buttons for 'Download on the App Store' and 'GET IT ON Google Play'. At the bottom, it says 'Keep your property lean and green to help protect your family and home.'



For specific guidelines & regulations

- Refer to ReadyforWildfire.org, California Department of Forestry & Fire Protection
- Your county, local agencies, & organizations



Invasive Plants



DO NOT PLANT
Mexican Feather Grass
Stipa tenuissima

👍 YES, PLANT
Blonde Ambition Blue Grama Grass
Bouteloua gracilis 'Blonde Ambition'

👍 YES, PLANT
Purple Three-awn
Aristida purpurea
Photo:
Calscape.org





Invasive Plants



DO NOT PLANT
Scotch Broom
Cytisus scoparius

👍 YES, PLANT
Forsythia
Forsythia x intermedia
'Spring Glory'



👍 YES, PLANT
Golden Current
Ribes aureum
Photo: PlantMaster



Photo: Monrovia



Plants *MANY* Choices

- Bark & Leaf Texture
 - Course, fine, rough, smooth, thick, thin
- Height, width, canopy
- Deciduous, evergreen
- Flower & fruit color
- Scent
 - Sweet, odiferous



Cercis occidentalis
Western Redbud



MANY Choices





Year-Round Interest



Manzanita
Arctostaphylos



Redbud
Cercis



Grevillea



Muhly
Muhlenbergia



Rosemary
Rosmarinus



Water-use Classifications



High
Moderate
Low
Very Low
None



Note: Once
Established





Defining “Established”

General Rules of Thumb

- Two to three times original size
- In ground for 1 to 1-1/2 years
- Trees – Can take 3 to 5 years or more
- ***ALL plants*** need consistent soil moisture when installed
 - Even plants that can survive only on seasonal moisture once established

Prunus caroliniana ‘Bright ‘n Tight’
Bright ‘N Tight Carolina Laurel





Plant Water-Use Classifications

- **High** – Consistent soil moisture throughout the year, even once established
 - Examples: Lawns (Turf) (Green Sponges), water-loving plants (Hydrangeas), container plants
- **Moderate** - Supplemental irrigation needed depending on season, location, rainfall, & adaptability of plant





Plant Water-Use Classifications

- **Low** – Adapted to Mediterranean-type climates & area-specific CA natives
 - Rest during warm, dry summer months
 - Grow during the cool, moist winter months
 - Periodic additional summer water
 - May or may not be drought tolerant
- **Very low** - *Some* California natives
 - Rely on seasonal rainfall
 - **NO** additional summer water (except winter drought)



Heteromeles arbutifolia, Toyon



Hydrozones for Plant Health & Efficient Use of Water

Hydrozone Challenge – All Low Water-use Plants

HYDROZONE TRIANGLE

Hydrozone means the grouping of plants by their water requirements for efficient irrigation and plant health.

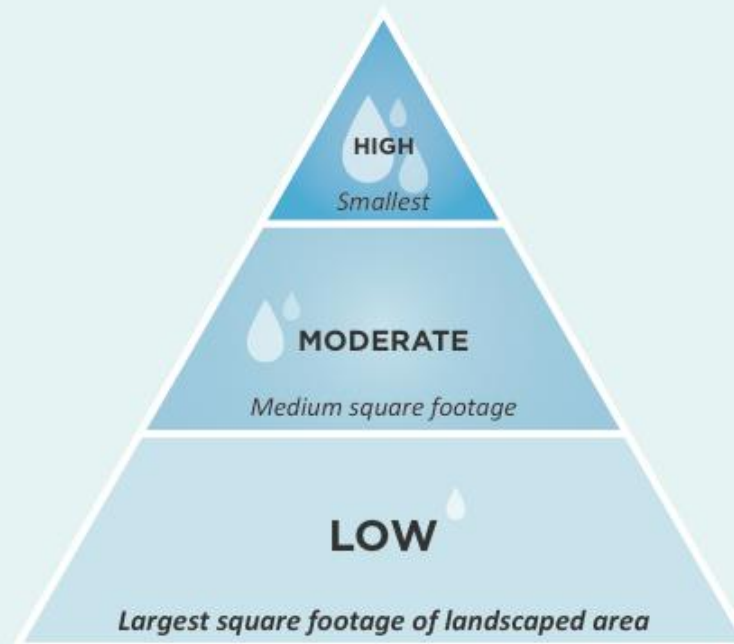

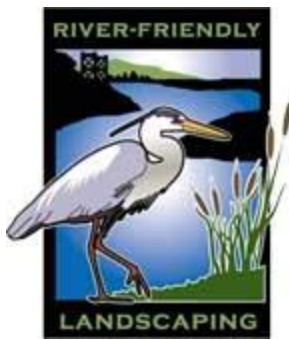

Hydrozones & Efficient Use of Water

- Separate valves (when possible) for
 - Trees
 - Lawn
 - Edibles, fruit trees, etc.
 - Potted plants
 - When keeping mature plants
 - Plants that rely on seasonal rainfall & little, if any, supplemental water (once established)
- What happens in existing landscapes?

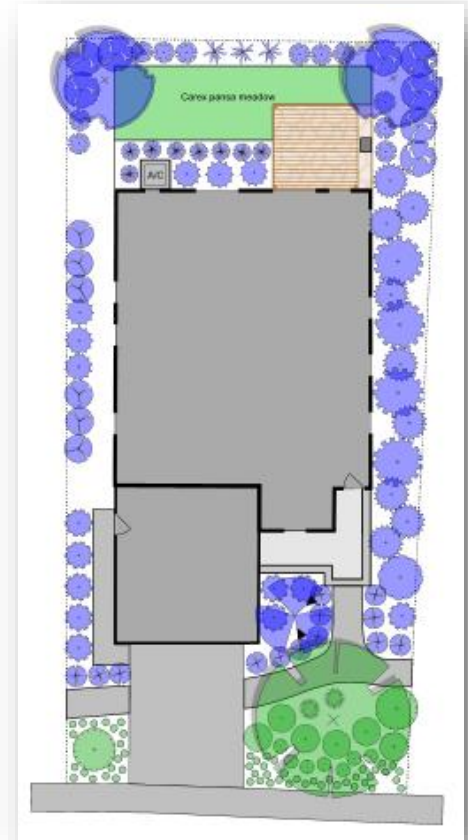

Correct Hydrozoning



Mixed Water-use Zones

- Do **NOT** mix plants with different water-use categories in same zone / same valve
- Wastes water, requires increased care, & results in plant death

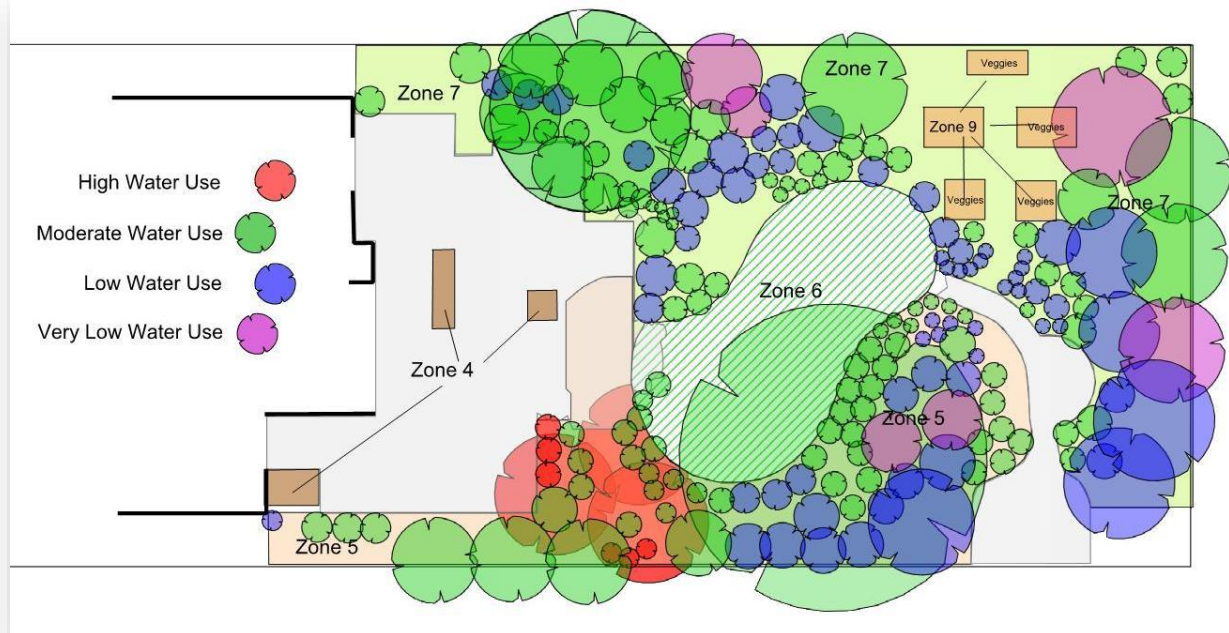

Incorrect
Hydrozoning

Hydrozone plan
Courtesy of
Lori Palmquist,
puddle-
stompers.com



Sun

- Determine direction site faces – Orientation
 - North-facing, South, East, West
- Time of day
 - Morning sun, afternoon, all day
- Length of time exposed to sun
- Obstructions
 - Houses, trees, etc., block sun
- Intense heat
 - Next to street, reflective heat from walls
- Seasonal angle changes

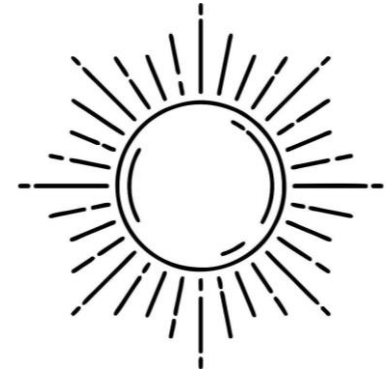



Example Plants

Low Water – Full Sun



Arbutus 'Marina'
Marina Madrone
Up to 30' Tall / 30' Wide Tree



- Direct sun all day
- 10 hours or more
- Tough conditions



Low Water – Full Sun to Part Shade

- Tolerate full sun & some afternoon shade
- 5 – 10 hours of direct sun



Hesperaloe parviflora
Coral Yucca
3-4' T / 3-4' Wide Shrub



Rosmarinus officinalis 'Mozart'
Ed Carmen's Rosemary
3' Tall / 6' Wide Shrub



Low Water – Full Sun to Part Shade



Salvia spathacea
Hummingbird Sage
1-2' Tall / 4'-5' Wide Perennial



Teucrium fruticans
Bush Germander
6-8' Tall / 12' Wide Shrub



Low Water – Full Sun to Part Shade

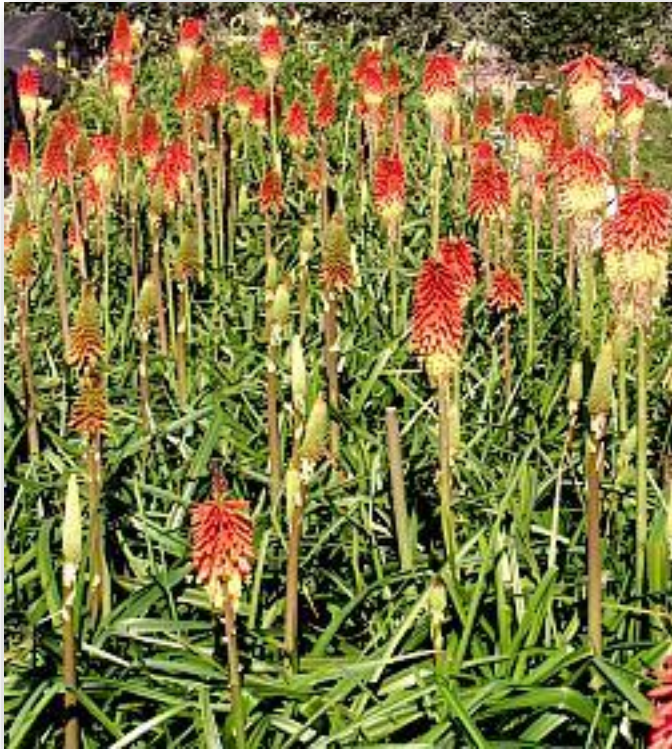

Kniphofia 'Christmas Cheer'
Christmas Cheer Poker Plant
3'-5' Tall / 3-5' Wide Perennial



Bouteloua gracilis
Blue Grama Grass
1-3' Tall / 1-3' Wide Perennial



Low Water – Part Shade

- Less than 5 hours of direct sun (mornings)
- Shade for half of day (afternoons)

Carpenteria californica
'Elizabeth'
Bush Anemone
4'-6' Tall / 4-6' Wide Shrub





Low Water - Part to Full Shade



Daphne odora 'Aureo-marginata'
Variegated Winter Daphne
4-6' Tall / 4-6' Wide Shrub



Ribes malvaceum
Chaparral Currant
2-3' Tall / 3-4' Wide Shrub
Groundcover



Low Water - Shade



Helleborus argutifolius
Corsican Hellebore
2-3' Tall / 2-3' Wide Perennial



Heuchera 'Lillian's Pink'
Lillian's Pink Coral Bells
1-1/2' Tall / 1' Wide Perennial



Let's Talk About Lawns

- Do you need grass? Then have it!
- Function, fits use
- Water it effectively & efficiently
- Use rotary- & precision-type nozzles
- **NO** runoff



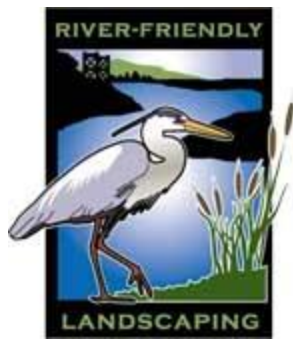

Reduce Unused Lawn



Kathleen Olson – After

- Create “**buffer zone**” between lawn & impermeable materials
- Watering CA native plants
- Consider sprinkler with rotatory nozzles to mimic rain, a brief shower
- Keep in mind mulch absorbs water
- AND we’re in a drought!
- Do you have rainwater stored?



Lower Water Lawn Options

Delta Bluegrass 90/10 Tall fescue
Festuca arundinacea, *Poa pratensis*, Blend

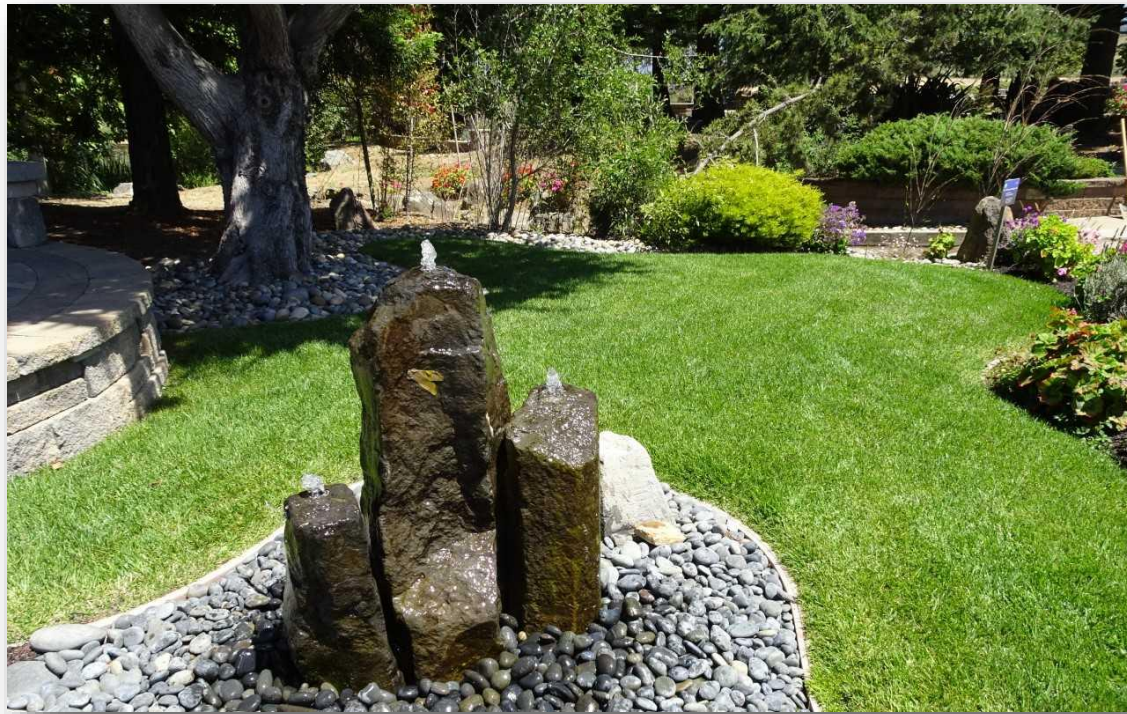

Photo: Delta Bluegrass



Lower-water Lawn Options

UC Verde Buffalograss

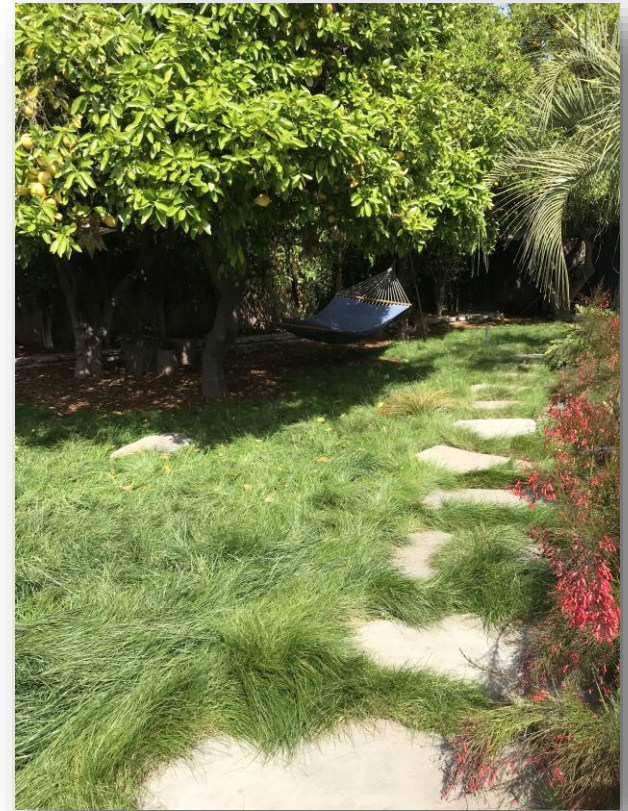

Photo: Florasource



Lower Water Lawn Option

- Uses about 50% less water than traditional turf
- Full sun, partial shade tolerance
- Clumpy, not for sports activities
- CA native & non-native
- Fine leaf blade for softer texture
- Can be maintained as turf lawn or left unmowed for meadow-like appearance
- Useful for erosion control on slopes



“No Mow” / “Mow Free”
Festuca idahoensis, *Festuca rubra*, *Festuca occidentalis*, blend



Lower Water Lawn Option

- Full sun, part shade
- Low-tolerance for foot traffic
- CA native, evergreen
- Spreads by underground stems
- Mow every 4-6 weeks encourages shoot growth

Just say *NO* to
synthetic turf



CA Field Sedge
Carex praegracilis



Lower Water Groundcover Option

- Full sun evergreen
- Blooms light lavender-pink spring, summer, fall
- Dense, flat in full sun, taller & not as compact in part shade
- Spreads by runners
 - Need to contain
- Excellent erosion control & on slopes
- Attracts bees



Phyla (Lippia) nodiflora, Kurapia
Photo: Delta Bluegrass



Lower Water Groundcover Option



Phyla nodiflora, Kurapia, used as front yard lawn substitute
Roxy Designs



Lower Water Groundcover Option

- Full sun, part shade
- Evergreen
- Yellow blooms in summer
- Spreads by underground stems
- Other than weeding, maintenance free
- Tolerates light foot traffic



Dymondia
Dymondia margaretae



Lawn Alternatives & Substitutes

The screenshot shows the Be Water Smart website. At the top, there is a navigation bar with 'HOME', 'ABOUT', and 'HOW DO I FIND?' menus, a search bar, and social media icons for Facebook, YouTube, and a calendar showing '31'. Below the navigation are two buttons: 'Sac Region Smart Irrigation Scheduler' and 'State Turf Replacement Rebate Program'. The main content area is titled 'Lawn Options' and features a sub-header 'Tired of Your Thirsty Turfgrass?'. The text explains that outdoor water use in the Sacramento region is high and that watering in the early morning and using WaterSense-labeled irrigation timers can reduce waste. It also discusses replacing traditional turfgrass with lower-water use plants. A photo shows a person's legs kicking a soccer ball on a grassy field. To the right, there is a 'Find Your Water Provider' section with a 'Search Now' button. Below that is a 'Save Our Water' graphic and a link to 'Learn more about California's Dry Conditions at saveourh2o.org'. At the bottom right, there is an 'Announcements' section with a link to '2019 Water Spots Video Contest Winners Announced'.

Be WATER SMART
Regional Water Authority

HOME ABOUT HOW DO I FIND? Search...

Sac Region Smart Irrigation Scheduler State Turf Replacement Rebate Program

Lawn Options

Tired of Your Thirsty Turfgrass?

Outdoor water use in the Sacramento region accounts for more than half of a household's total water use, which can be 250 gallons per day in the summer. About 30 percent of outdoor water use is wasted from evaporation and overwatering. Watering in the early morning hours and installing WaterSense-labeled irrigation timers can reduce this water waste.



Another option is to replace traditional cool season turfgrass with lower-water use plant options like turfgrass alternatives and turfgrass substitutes/ground cover plants. These plants are more suited to the Sacramento region's Mediterranean climate.

Turfgrass alternatives are low-water use grasses that have the look and feel of turf grass but require half the water to thrive.

Turfgrass substitutes are lawn-like small plants that grow together to cover an area and have the same lush green appearance of traditional turf grass with less maintenance (limited mowing needed!).

Find Your Water Provider
Not sure which district is your water provider?
Search Now

Save Our Water
Learn more about California's Dry Conditions at saveourh2o.org

Welcome to the Sacramento Region Smart Irrigation Scheduler
BASED ON CURRENT WEATHER

Announcements
2019 Water Spots Video Contest Winners Announced

<https://bewatersmart.info/lawn-options/>



Ditch the Strip



- Diversity of plants
- Year-round interest
- Drip instead of sprinklers
- Prevent that runoff!

California Native Plants Low Water & Full Sun to Part Shade

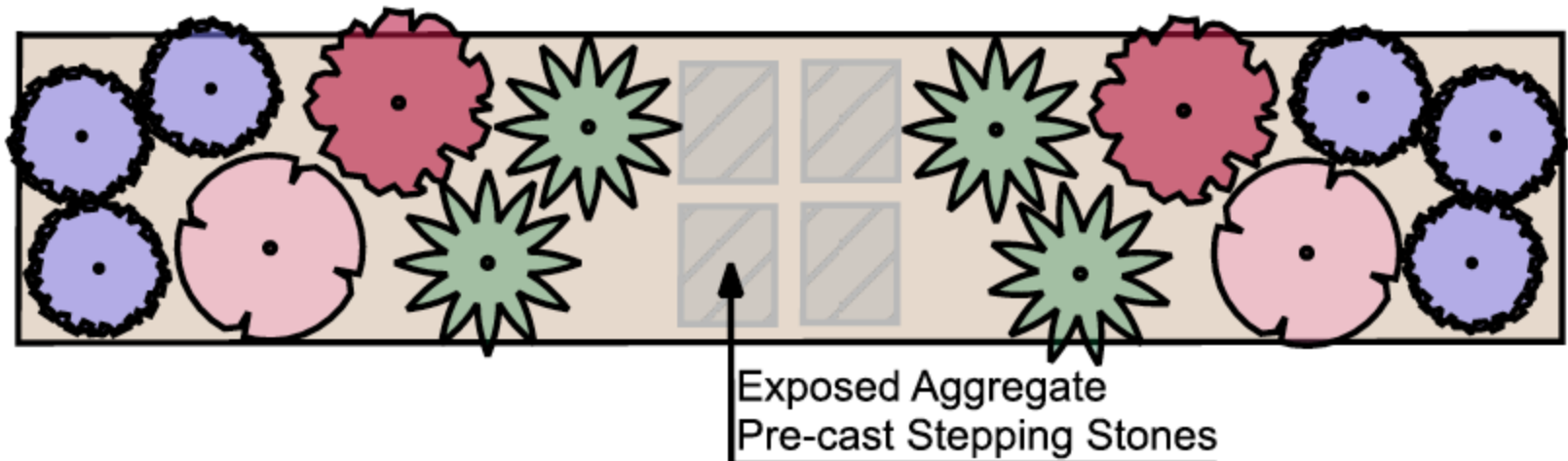



Pollinators



Attract & Support

- Birds, Bees, Bats, Butterflies...
- They need us & we need them
- Landscapes are interconnected ecosystems of living creatures
- Provide habitat – More than just “plants”
- Use local CA native & plants adapted to soil & climate
- Plants of varying heights for nesting & security



Pollinators



- Food - Succession of bloom throughout the year
- Various flowers, sizes ,and colors
- Clumps of plants (not just onesies)
- Sunny locations
- WATER

Honey Bee Haven

Three cartoon bees are flying around the text 'Honey Bee Haven'. One is at the top, one is to the right, and one is at the bottom left.

Learn more at:

- [CNPS Calscape](#)
- [Xerces Society](#)
- [Pollinator Gardens](#)



Spacing & Placing Plants

- Use plants that fit the space
- Easy care, less pruning
- Consider mature height & width
- Allow time for plants to get established & spread



Loropetalum, Fringe Flower

Placing Trees

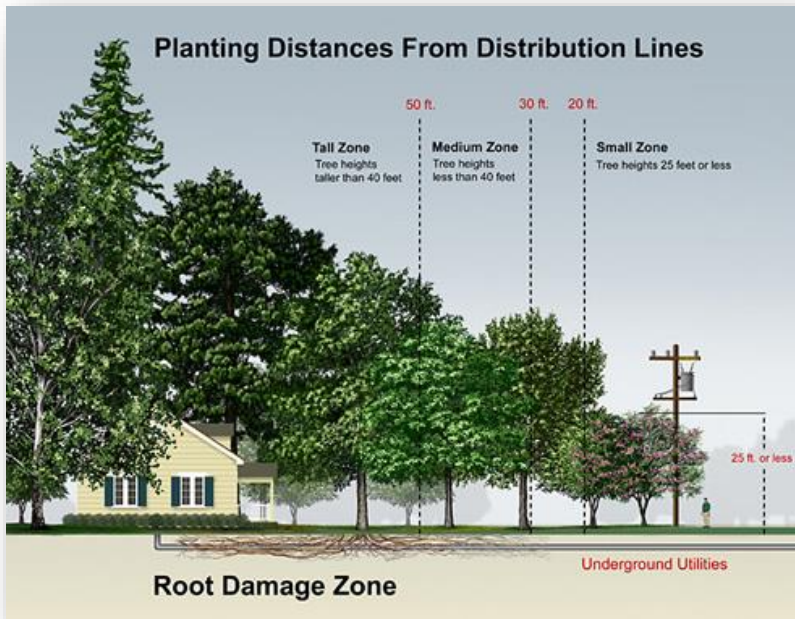

- When placing, look up, look down, & look out
- Deciduous trees on west & southwest side of house
- Consider solar panels, height & shade from tree
- Consider distance from structures, underground, & overhead utilities
- **DO NOT** top trees



Going Against Nature

This

Results in

This





Natural Shape *Beautiful!*

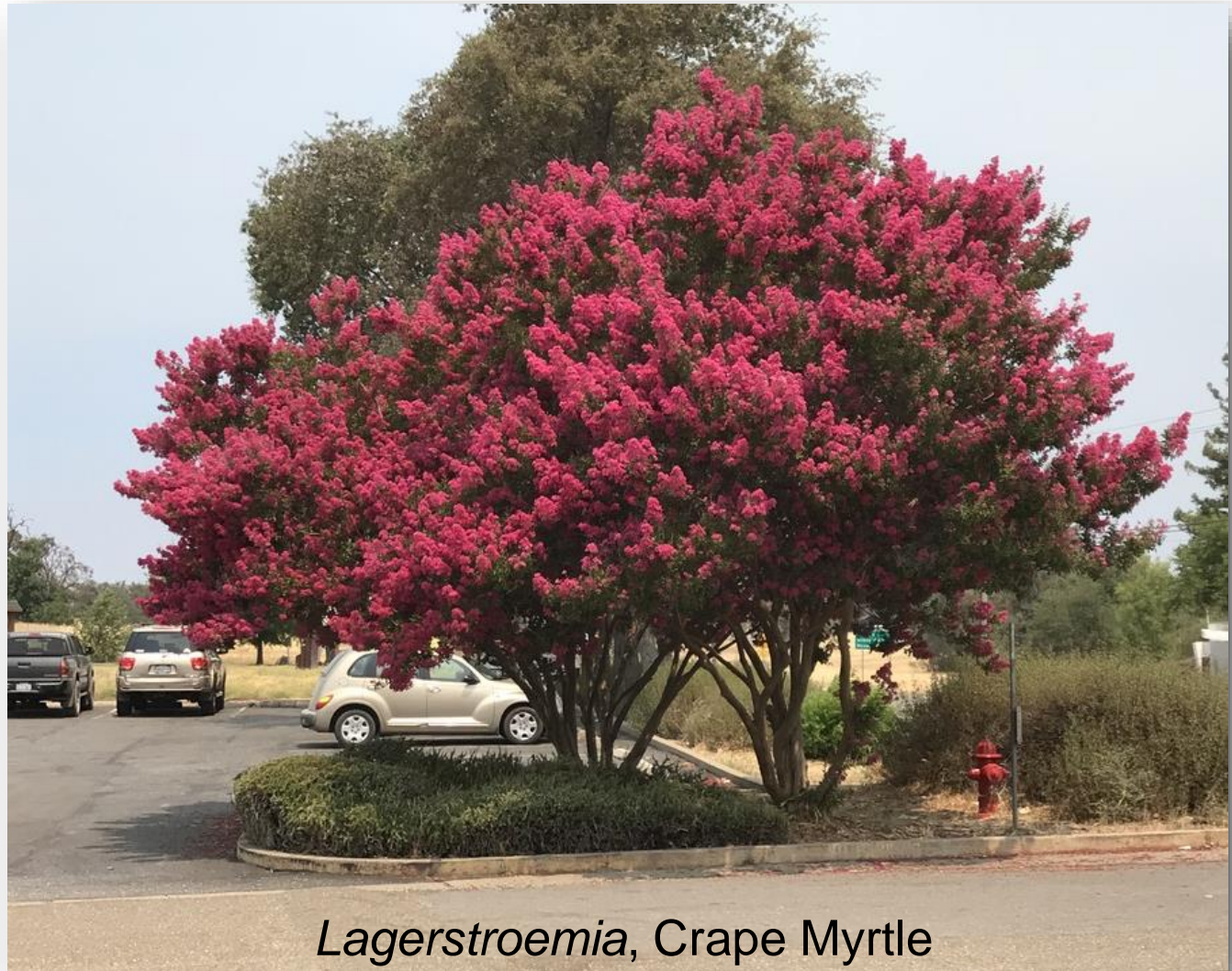

Lagerstroemia, Crape Myrtle

Young to Mature





Planting Trees

Give them a Chance to Thrive

- Fall = Perfect time!
~~ **NOT Now** ~~
- Before you dig, call U.S.A. 811
- Hole no deeper than root ball & twice as wide
- Fill hole with water
- Score sides of hole
- Check plant roots & loosen
- Root ball on undisturbed soil

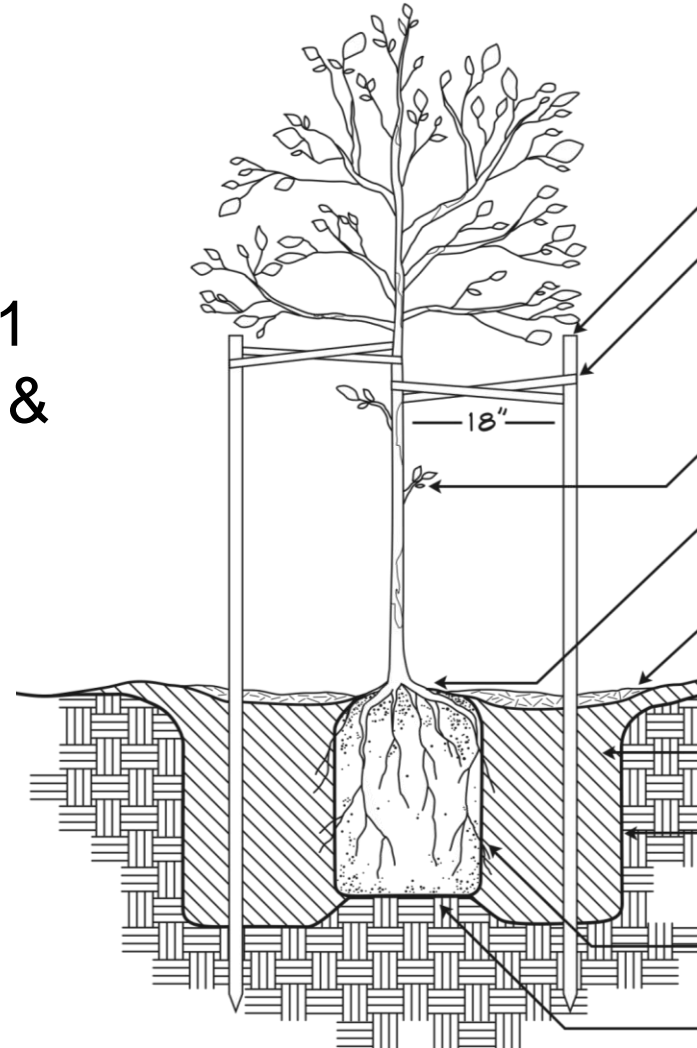



Plant
Sacramento Tree Foundation
healthier communities by
planting trees.

Volunteer
Help plant trees where you
live, work, and play.

Learn
Understand why trees
matter and learn how to
plant and care for them.

Join
Bring lasting change to our
region, one tree at a time.

Q SEARCH

Days Since Rain

0 0 4

Plant High

Watch this video to learn how to properly plant a tree so it may live a long and healthy life.

Watch Video

Planting Trees

Sacramento Tree Foundation

- Break up soil removed from hole
- Add worm castings for slow release of nutrients
- Fill hole with original soil, water as you fill
- Gently press soil around roots
- Top of root ball slightly above grade & no soil on it
- WATER ~ WATER ~ WATER
BEFORE, DURING, & AFTER



Stake Trees ONLY IF Needed

- Always remove nursery stake
- Stakes
 - Just tall enough to support
 - Don't interfere with canopy
 - In ground deep to be rigid
 - Outside root ball
- Flexible ties
 - Lowest point yet still supporting
 - Figure eight
 - Tack or tie to prevent sliding
- Stakes **NOT** permanent
 - Test, release, re-tie (?), REMOVE

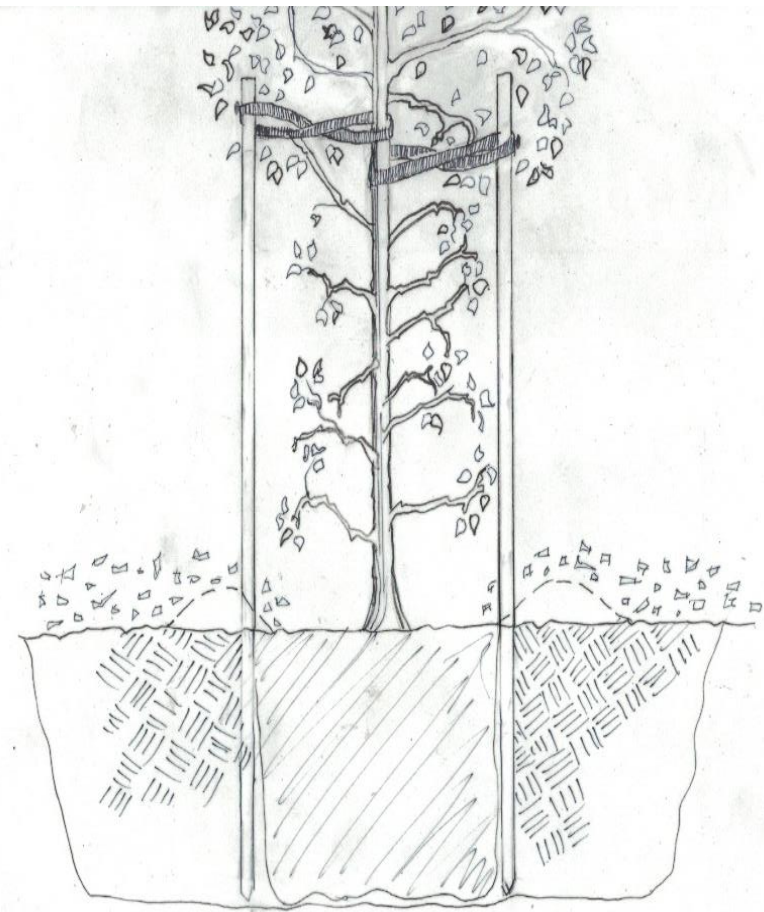
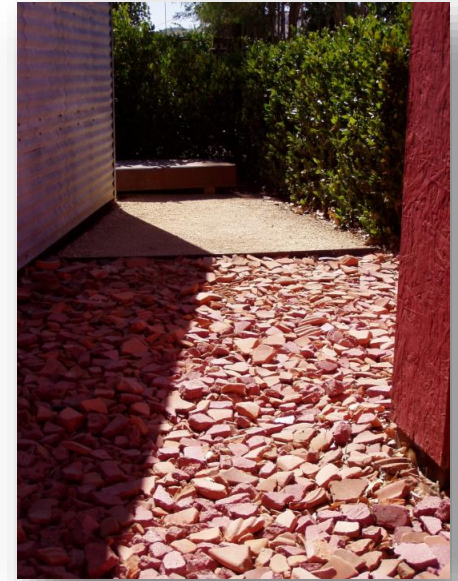



Diagram: Marcia Scott
Marcia J. Scott Landscape Designs



What is MULCH & Why Use It?

- Really... Any material spread over the soil surface
- But... organic materials best for soil & to enhance growth of plants & appearance of the landscape
- Who can list some benefits?



Use THIS 
THIS 

NOT



Mulch Mistakes



NO THANKS!

Please say **NO** to

- Landscape fabric
- Plastic
- Rocks, gravel
- Rubber



Mulch Preparation & Application

MULCH DIAGRAM

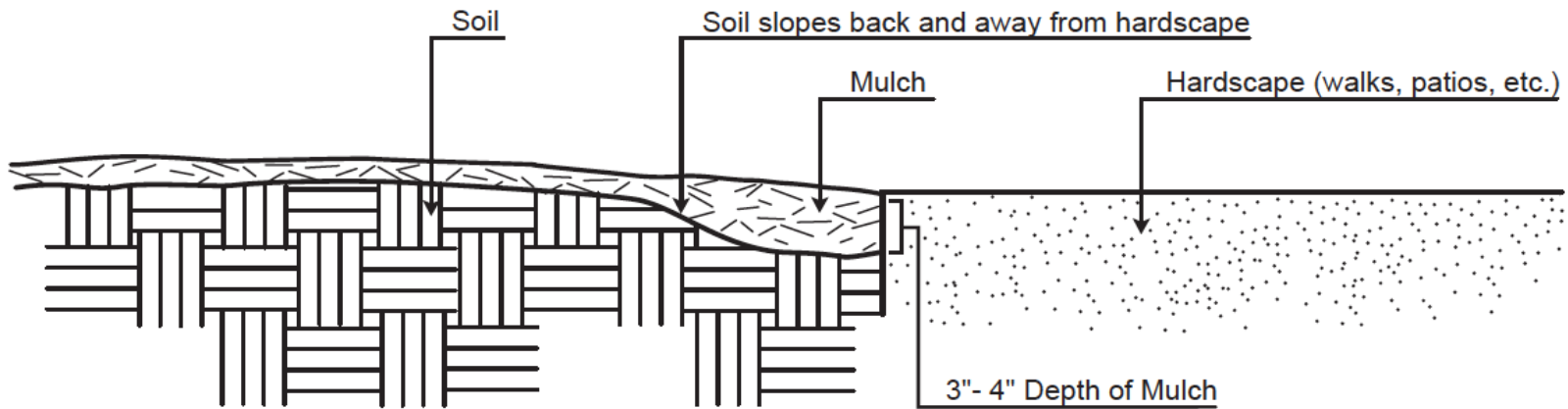

Use soil excavated from hardscape edges to form mounds & contours

Diagram: Landscape Liaisons & EcoLandscape California



Green (Living) Mulch = Plants



- Groundcover layer = Cover crops (e.g., clovers)
- Living mulch prevents water runoff & soil erosion, improves soil fertility & quality, suppresses weeds, promote plant diversity
- Reduce energy use



Highly-efficient Irrigation

- Use weather-based irrigation controller with rain sensor
- Effective irrigation strategies deliver water in a widespread, uniform manner
 - Grid pattern using dripline tubing with built-in emitters



Design-Build Contractor
Martin Carrion van Rinjn
Landscape Symphonies



BeyondTheDrought.com

Register | Log in

Welcome to the Sacramento Region Smart Irrigation Scheduler

NEW Features

BASED ON CURRENT WEATHER

Calculates run-time minutes per week for a single sprinkler or drip zone. [See videos](#)

- NEW** • Scheduling for drip zones is included.
- Register to save multiple zones & controllers.

Closest city (required)

Zip code (required) [Help](#)

Watering restrictions

[What are my city's restrictions?](#)

GO ➔

Provided with the generous [support](#) of Water Forum

Set up Zone

City: **Folsom** [edit](#)
Zip: **95630** [edit](#)
Days per week allowed: **Any** [edit](#) Zone 1

Plant Material *Choose one* [i](#)

Low Water Use	Moderate Water Use	Mixed Plants	Warm Season Turf	Cool Season Turf

Exposure *Choose one* [i](#)

Shade	Part Sun	Full Sun

Wind *Choose one* [i](#)

Very Little	Moderate	High

Slope *Choose one* [i](#)



Efficient Irrigation Strategies

- Flowing, organic patterns
- Site-specific challenges

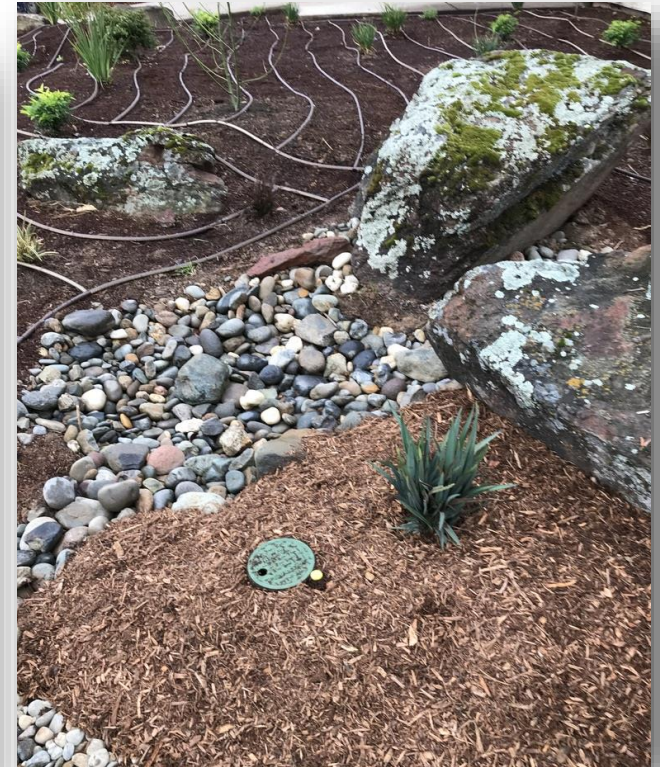
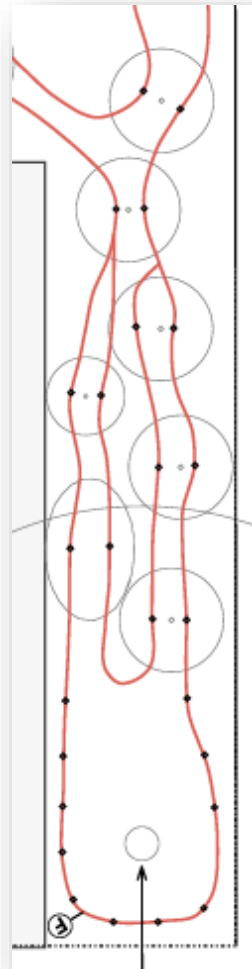
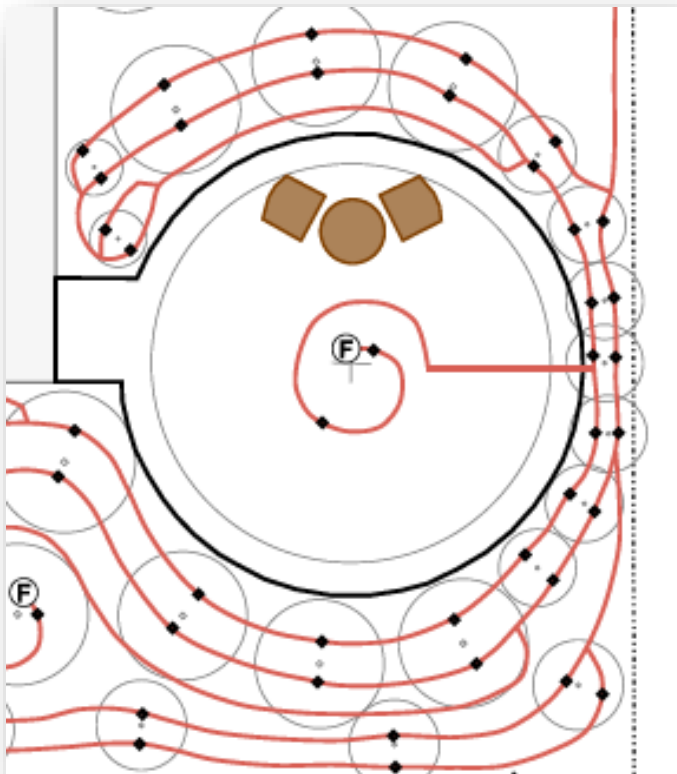

TREE EMITTERS - EXAMPLE PLACEMENT

●—● In-line / Dripperline Emitters

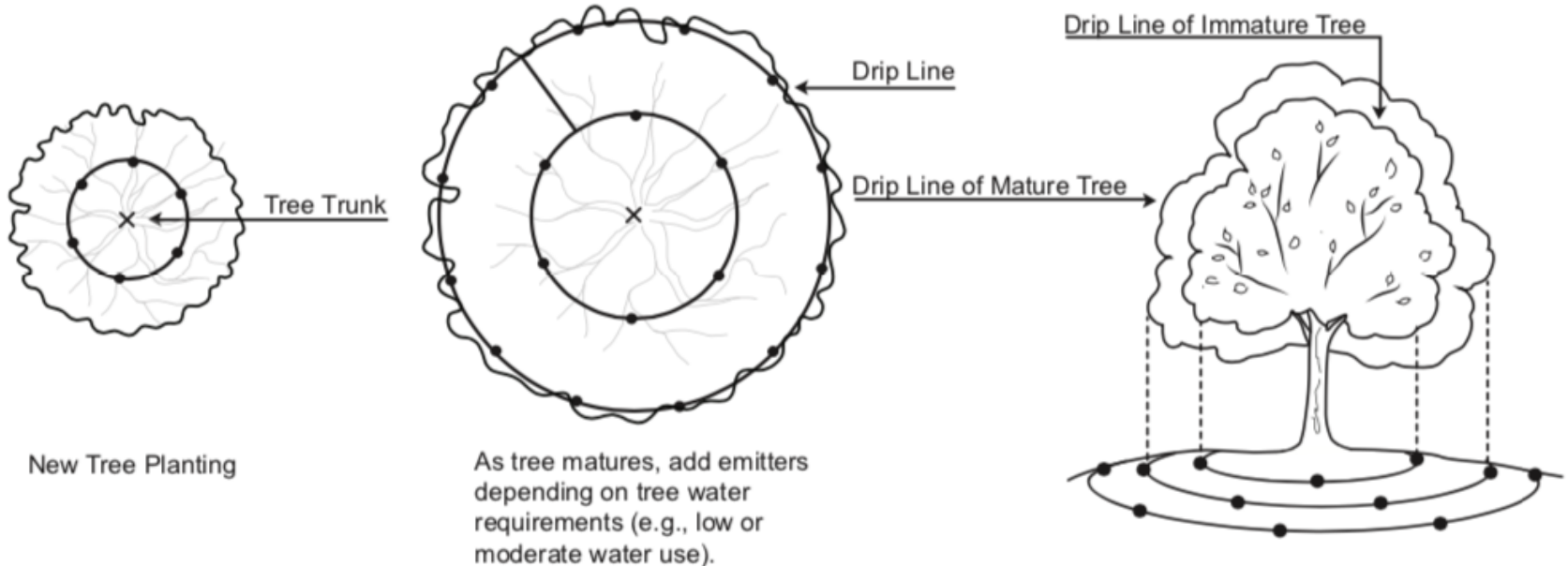

NOTE: - The spacing and number of emitters are examples. - Specific spacing and number of emitters will depend on plant size at installation, plant water requirements, soil type, and emitter flow rate.

- Emitters not in contact with trunk/base of plant
- As plant matures, adjust placement
- Depending on species, add or remove emitters
- Replacing single plant, *hand water*
- Entire root zone receives water



Establish Plants for Resilience

- Newly installed plants
 - Must have water on root ball & existing soil
 - Bridges interface between both soil types
 - Encourages roots to extend into existing soil
- As tree/plant matures & based on water needs of species, extend intervals between watering to allow soil to dry down





Bringing it All Together

- Water efficient
- Hydrozones
- Shade & fruit trees
- CA natives
- Green islands
- Rain garden
- Fire wise
- Pollinator friendly

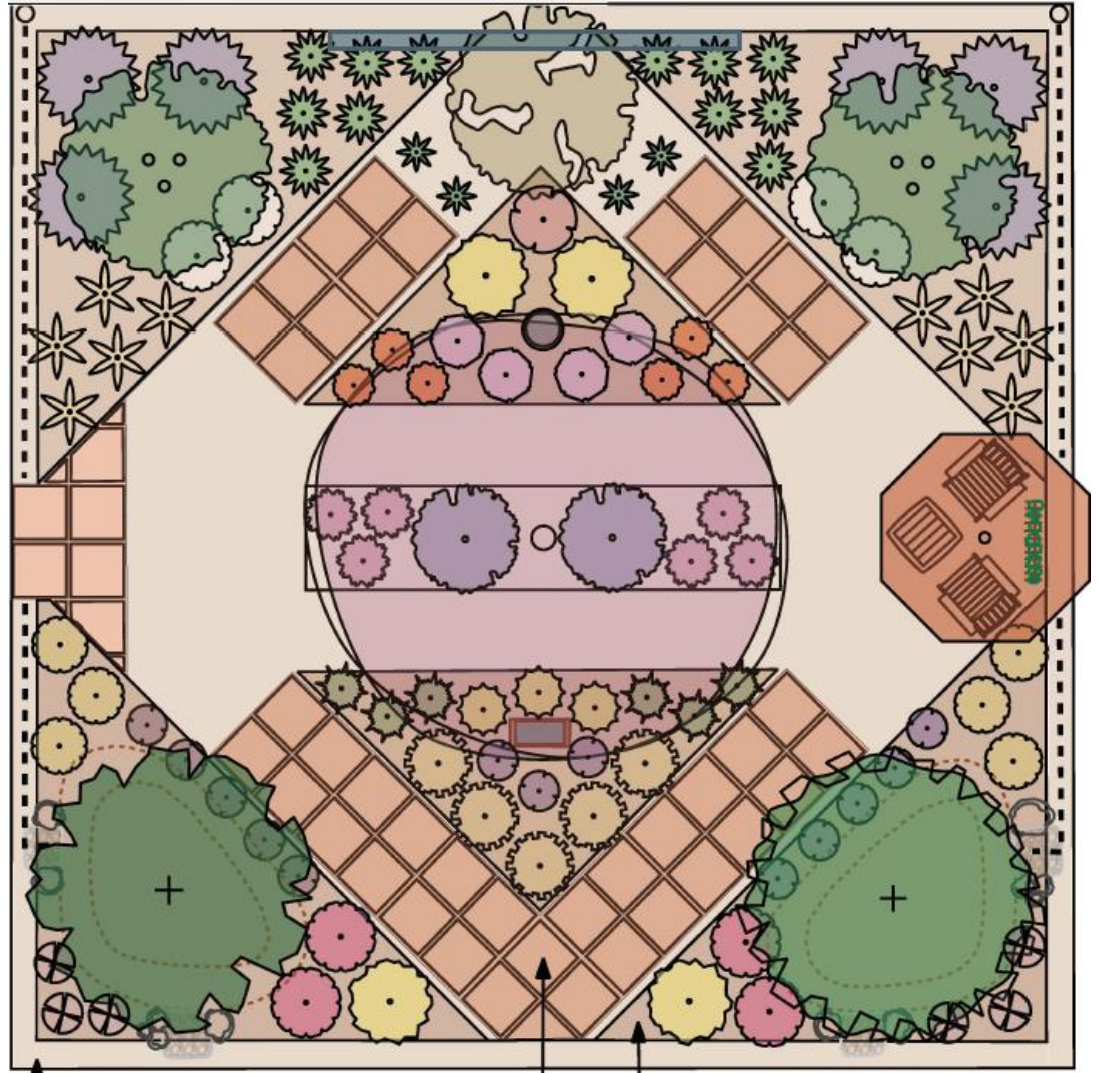



Caring for Your Garden in Summer

- Call for a [Water-Wise House Call](#)
- Turn on irrigation system weekly
- Look & listen for leaks
- Make repairs ASAP
- Adjust misdirected sprinklers
- Adjust emitter placement if needed
- Check soil moisture before watering





Caring for Your Garden in Summer

- Monitor & *manage* pests & diseases
 - [UC Integrated Pest Management \(IPM\)](#)
- Look for signs of plant stress
- Investigate
- Hand pull weeds
- Sprinkle worm castings around base of plants
- Replenish mulch, maintain 3 to 4-inch layer
 - NOT in contact with base of plants
- Lawns - Use mulching mower
- Let grass grow taller – Who knows why?





Caring for Your Garden in Summer

- **NOT** the time to plant ornamentals
- **NOT** time to prune, unless
 - Dead, damaged, diseased, crossing branches
 - Removing spent blooms to encourage repeat bloom
 - Some exceptions with natives
- ALWAYS clean pruning tools
- Slowly & deeply water trees
 - [Sacramento Tree Foundation](#)
 - Trees Are Good by [ISA](#)
- Provide water for pollinators...

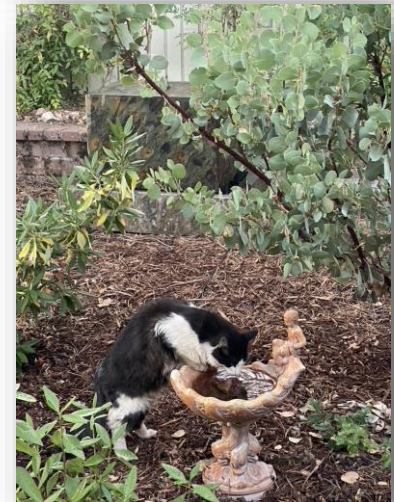



Resources

Water-use Classifications

WUCOLS IV

Water Use Classification of Landscape Species

Plant Search Database

If you know exactly which plant you are interested in, you may search for it by name (partial names are OK, too). Otherwise, consider searching by plant type and/or water use.

[See WUCOLS List for All Regions](#)

City

Search for a city: — or —

Plant Name

Water Use

- Very Low
- Low
- Moderate/Medium
- High
- Unknown
- Not Appropriate for this Region

Plant Type

- Gc** (Ground Cover)
- P** (Perennial)
- S** (Shrub)
- T** (Tree)
- V** (Vine)
- Ba** (Bamboo)
- Bu** (Bulb)
- G** (Ornamental Grass)
- Pm** (Palm and Cycad)
- Su** (Succulent)
- N** (California Native)
- A** (Arboretum All-star)

[Looking for Turf Grass?](#)

https://ucanr.edu/sites/WUCOLS/Plant_Search/

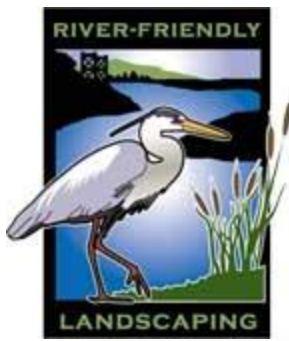

Resources

BeWaterSmart.info

HOME ABOUT HOW DO I FIND? d

Rebates & Services

Click the tab titles below to find out more.

Rebates Services Green Gardener

Many of the water providers in the Sacramento region provide rebates for customers to

A Homeowner's Guide to a WaterSmart Landscape

A photograph of vibrant pink flowers, likely a flowering shrub, used as a background for the guide title.

HOME ABOUT HOW DO I FIND? Search

DWR's Toilet and Turf Replacement Program d

Rethink Your Yard

Sacramento-area residents did an outstanding job conserving water during California's historic drought. A big reason was their willingness to limit outdoor watering, which is where most household water use occurs.

For many people, the drought gave them an opportunity to rethink the way they view and use their landscape and to consider whether it's time for a change.

Check out the stories below of those who decided to rethink their yards—and the benefits they found by moving from a thirsty landscape to a beautiful, low-water use lifestyle.

Find Your Water Provider
Not sure which district is your water provider?
Search Now

Save Our WATER

Learn more about California's Dry Conditions at saveourh2o.org

MAUREEN & RICH

#RETHINK YOUR YARD
INSPIRED NEIGHBORS TO CONSERVE

BeWaterSmart.info

Check the Soil and Save
Free Moisture Meters Available!

Learn More

Check the Soil and Save

Free Moisture Meters Available!

Learn More

Water-Wise Gardening in the Gold Country Region

Be WATER SMART
Regional Water Authority

Find Your Water Provider
Want to contact your water provider about great rebates and programs?

Water Saving Tips:
Mulching and adding compost to soil can minimize evaporation and help soil absorb and store water.

Facebook, Twitter, Email, YouTube, RSS, 70

Resources

BeWaterSmart.info

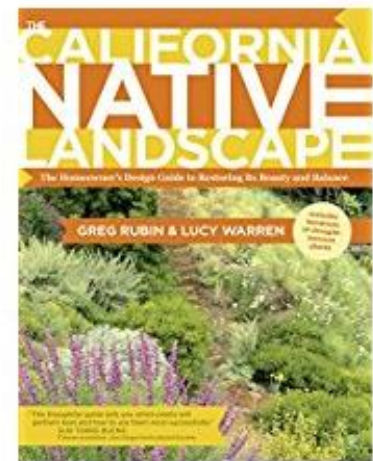
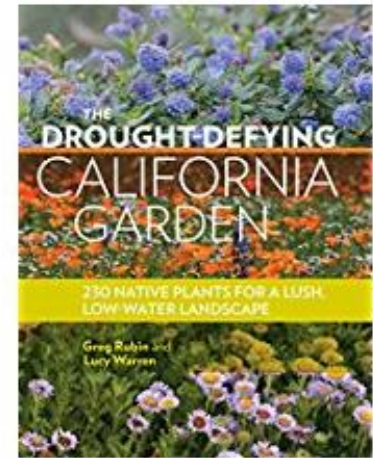
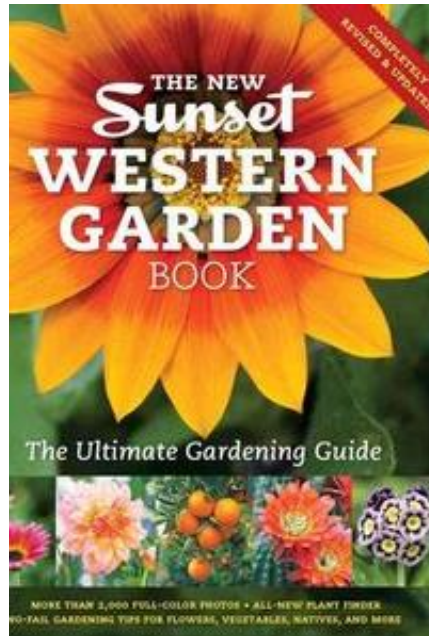

CNPS
California Native Plant Society

About CNPS Chapters Join/Support Publications Shop Conservation

Calscape *Restore nature one garden at a time*

Enter a California address to

Plants native to **California**

 All Plants (6985)	 Trees (203)	 Shrubs (910)	 Perennials (3516)
 Annuals (2194)	 Grasses (690)	 Succulents (186)	 Vines (56)

CalScape.org



Resources

roseville.ca.us/plantlist

WaterSmart Plant List for the Sacramento Region

- Uses & Benefits
- Water-use classifications
- More California native plants
- Common names linked to online photos & more

WaterSmart Plant List for the Sacramento Region
 Very Low, Low, and Moderate Water-Use
 Perennials

Genus	Species	Variety / Cultivar / Hybrid	Common Name	Water Use	Plant Type	Exposure	Climate Zone	Mature Size Tall (T) / Wide (W)	Plant Coverage Value (Sq. Ft.)	Bloom Color / Season							
Perennials											Uses / Benefits						
<i>Achillea</i>	<i>filipendulina</i>		Fernleaf Yarrow	L	Evergreen to Semi-evergreen	FS	A1-A3, 1-24	4-5' T / 1-3' W	3	Yellow / Spring-Fall	Y		Y			Y	Y
<i>Achillea</i>		hybrids	Yarrow	L	Semi-evergreen	FS/PS	1 to 24	1-2' T / 1-3' W	3	White, Lavender, Salmon / Spring, Summer, Fall	Y		Y			Y	Y
<i>Achillea</i>	<i>millefolium</i>	'Island Pink'	Island Pink Yarrow	L	Semi-evergreen	FS/PS	1 to 24	1-2' T / 1-3' W	3	Pink / Spring, Summer, Fall	Y	Y	Y	Y		Y	Y
<i>Achillea</i>	<i>millefolium</i>	'Moonshine'	Moonshine Yarrow	I	Semi-evergreen	FS/PS	1 to 24	2' T / 1-3' W	3	Yellow / Spring, Summer, Fall	Y		Y			Y	Y



Eco-Friendly Landscape Design Plans for The New California Landscape

FREE Four Complete Landscape & Irrigation Plans

- 75 Plant Profiles
- Irrigation Equipment
- Guided Verbal Tours of Plans
- **Interactive Designs:** See plants, features, & learn about water-saving irrigation equipment and practices

Visit Download Learn



Botanical Name: *Arbutus* 'Marina'
Common Name: Marina Strawberry Tree
 AR-bu-tus

TREE



Spring



Summer



Fall



Winter

Family: Ericaceae
Origin: San Francisco, CA
Climate Zone: USDA 7-9, Sunset 8, 9, 14-24
Mature Height: 20-30 feet
Mature Width: 12-20 feet

Soil: Plant high, in well-drained soils rich in organic matter
Exposure: Full sun to part shade
Water Requirements: Low, do not overwater
WUCOLS Water Needs: L L M M L L

<https://puddle-stompers.com/waterwonk/new-ca/>



Resources



Find a
Designer

Full Address	within 50 mi	Go
California	Designer Name	

Our Newest Handbook

Download *California Watershed Approach to Landscape Design*, which was made possible through a collaboration with Green Gardens Group (G3), California Water Efficiency Partnership (CalWEP), and Surfrider Foundation.



Association of Professional Landscape Designers
California Chapter ~~ apldca.org



Who Can Assist you?

- Landscape Designers <https://apldca.org/>
- California Landscape Contractors Association <https://clca.org>
- ReScape <https://www.rescapeca.org>
- UC Master Gardeners <https://mg.ucanr.edu>
- Your water provider!

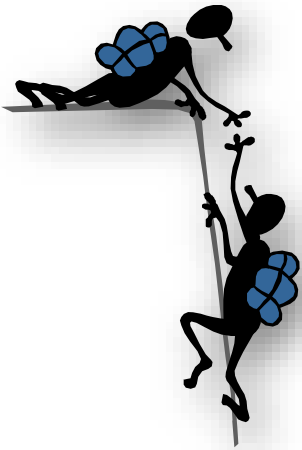



Acts of Kindness -- Give Your Garden Some Love



Soleil Tranquilli's Garden



Cheryl Buckwalter
Landscape Liaisons

landscapeliaisons@gmail.com

All Rights Reserved