

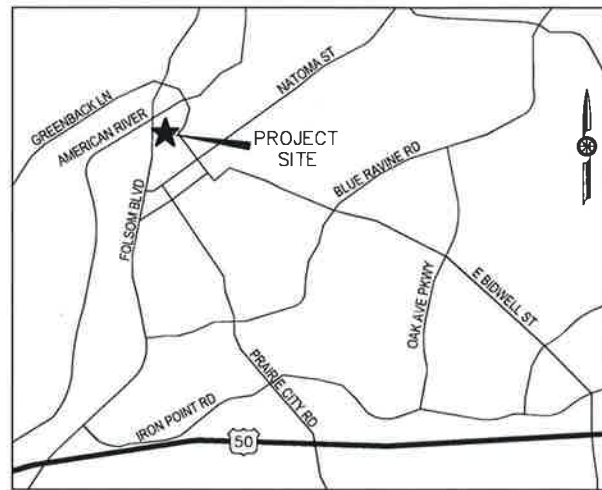

CITY OF  
**FOLSOM**  
DISTINCTIVE BY NATURE

# TRADERS LANE PARKING LOT AT LEIDERSDORFF STREET AND RILEY STREET IMPROVEMENTS

IN THE CITY OF FOLSOM, COUNTY OF SACRAMENTO  
PROJECT NO. XXX



VICINITY MAP  
SCALE: NTS

CONTROL POINTS				
POINT #	ELEVATION	NORTHING	EASTING	DESCRIPTION
100	195.28	2009644.25	6796309.69	MAG NAIL
101	195.21	2009854.22	6796616.72	MAG NAIL
102	193.79	2009798.64	6796367.96	MAG NAIL

**DATUM NOTE**  
HORIZONTAL DATUM: NAD 83 CALIFORNIA ZONE 2 AS ADJUSTED TO NGS PID DK2861  
VERTICAL DATUM: NAVD 29 AS ADJUSTED TO CITY OF FOLSOM BENCHMARK #18. BENCH A BRASS DISK STAMPED "CITY OF FOLSOM B.M. 18" ABOVE A D.I. AT THE BACK OF CURB IN FRONT OF A FIRE HYDRANT ON THE WEST SIDE OF SIBLY ST (PRAIRIE CITY ROAD). ELEVATION = 217.08 FEET

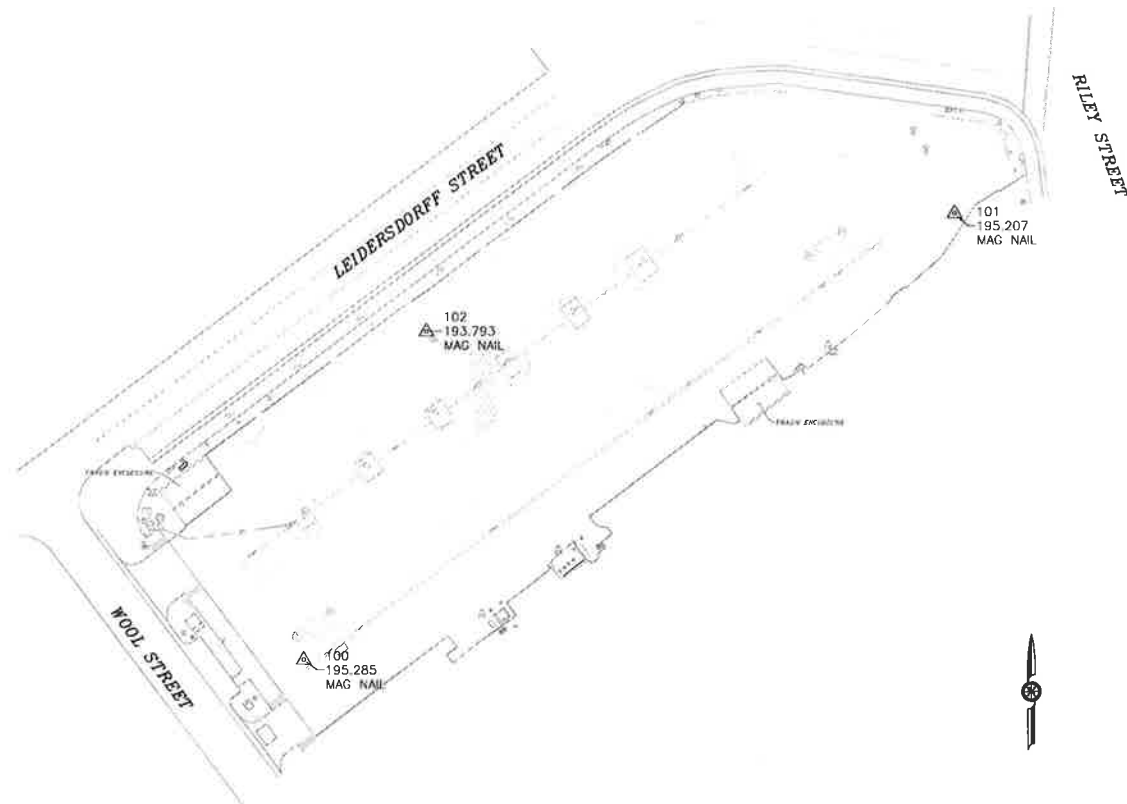

LOCATION MAP  
NOT TO SCALE

**GENERAL NOTES:**

- ALL WORK SHALL BE DONE IN ACCORDANCE WITH THE CURRENT CITY OF FOLSOM STANDARD CONSTRUCTION SPECIFICATIONS AND PLANS, AND THE LATEST EDITIONS OF THE STATE OF CALIFORNIA, DEPARTMENT OF TRANSPORTATION STANDARD SPECIFICATIONS AND STANDARD PLANS, CALIFORNIA MUTCD, AND SHALL BE COMPLETED TO THE SATISFACTION OF THE ENGINEER.
- IT IS THE RESPONSIBILITY OF THE CONTRACTOR TO PAY AND OBTAIN PERMITS NECESSARY TO PERFORM THE WORK SHOWN ON THESE PLANS FROM THE APPROPRIATE AGENCIES.
- CONTRACTOR SHALL OBTAIN AN ENCROACHMENT PERMIT FROM THE CITY OF FOLSOM AND SHALL VERIFY THAT THE ENCROACHMENT PERMITS ARE FILED WITH THE CITY. THE CONTRACTOR SHALL NOTIFY THE ENGINEER 3-WORKING DAYS PRIOR TO PERFORMING ANY WORK WITHIN PUBLIC RIGHT-OF-WAY OR EASEMENT.
- THE CONTRACTOR SHALL PRACTICE SAFETY AT ALL TIMES AND SHALL FURNISH, ERECT AND MAINTAIN SUCH FENCES, BARRICADES, LIGHTS AND SIGNS NECESSARY TO GIVE ADEQUATE PROTECTION TO THE PUBLIC AT ALL TIMES. TEMPORARY TRAFFIC CONTROL SHALL BE APPROVED BY THE ENGINEER.
- INFORMATION SHOWN ON ALL EXISTING IMPROVEMENTS ON THESE DRAWINGS IS TAKEN FROM FIELD SURVEY. THE CONTRACTOR SHALL VERIFY LOCATIONS OF ALL IMPROVEMENTS PRIOR TO BEGINNING OF WORK.
- THE CONTRACTOR SHALL HAVE COPIES OF THE APPROVED PLANS AND SPECIFICATIONS FOR THIS PROJECT ON THE SITE AT ALL TIMES, AND CONTRACTOR SHALL BE FAMILIAR WITH ALL APPLICABLE STANDARDS AND SPECIFICATIONS.
- THE CONTRACTOR AGREES THAT, IN ACCORDANCE WITH GENERALLY ACCEPTED CONSTRUCTION PRACTICES, THE CONTRACTOR WILL BE REQUIRED TO ASSUME SOLE AND COMPLETE RESPONSIBILITY FOR JOB SITE CONDITIONS DURING THE COURSE OF CONSTRUCTION OF THE PROJECT, INCLUDING SAFETY OF ALL PERSONS AND PROPERTY. THIS REQUIREMENT SHALL BE MADE TO APPLY CONTINUOUSLY AND NOT BE LIMITED TO NORMAL WORKING HOURS. THE CONTRACTOR FURTHER AGREES TO DEFEND, INDEMNIFY, AND HOLD OWNER AND ENGINEER HARMLESS FROM ANY AND ALL LIABILITY, REAL OR ALLEGED, IN CONNECTION WITH THE PERFORMANCE OF WORK ON THIS PROJECT, EXEMPTING LIABILITY ARISING FROM THE SOLE NEGLIGENCE OF THE ENGINEER.
- SHOULD IT APPEAR THAT THE WORK TO BE DONE OR ANY MATTER RELATIVE THERETO IS NOT SUFFICIENTLY DETAILED OR EXPLAINED ON THESE PLANS, THE CONTRACTOR SHALL REQUEST IN WRITING FROM THE ENGINEER SUCH FURTHER EXPLANATIONS AS MAY BE NECESSARY PRIOR TO COMMENCEMENT OF SAID WORK.
- ALL DIMENSIONS ARE IN FEET UNLESS OTHERWISE NOTED.
- THE CONTRACTOR SHALL BE RESPONSIBLE FOR DETERMINING THE EXACT LOCATION OF ALL EXISTING UTILITIES AND FOR THE PROTECTION OF AND REPAIR OF DAMAGE TO THEM. CONTACT UNDERGROUND SERVICE ALERT, 1-800-227-2600, TWO (2) WORKING DAYS BEFORE WORK IS TO BEGIN.
- THE CONTRACTOR SHALL BE RESPONSIBLE FOR CONTACTING THE RESPECTIVE UTILITIES COMPANIES, AND THE CITY, FOR VERIFICATION AT THE SITE, OF ANY POSSIBLE CONFLICTS WITH THEIR UNDERGROUND UTILITIES NOT PREVIOUSLY SHOWN ON THESE PROPOSED IMPROVEMENTS PLANS.
- THE TYPES, LOCATIONS, SIZES AND DEPTHS OF EXISTING UNDERGROUND UTILITIES AS SHOWN ON THESE IMPROVEMENT PLANS WERE OBTAINED FROM SOURCES OF VARYING RELIABILITY. THE CONTRACTOR IS CAUTIONED THAT ONLY ACTUAL EXCAVATION WILL REVEAL THE TYPES, EXTENT, SIZES, LOCATIONS AND DEPTHS OF SUCH UNDERGROUND UTILITIES. NEITHER THE CITY OF STOCKTON NOR ITS CONSULTANT, BENNETT ENGINEERING SERVICES, CAN ASSUME THE RESPONSIBILITY FOR THE COMPLETENESS OR ACCURACY OF THE DELINEATION OF SUCH UTILITIES NOR THE EXISTENCE OF OTHER BURIED OBJECTS OF SUCH UNDERGROUND UTILITIES WHICH MAY BE ENCOUNTERED BUT WHICH ARE NOT SHOWN ON THESE IMPROVEMENT PLANS.
- CONTRACTOR SHALL INSTALL APPLICABLE EROSION CONTROL MEASURES IN ACCORDANCE WITH THE LATEST EDITION OF CALIFORNIA STORMWATER QUALITY ASSOCIATION BMP'S.
- CONTRACTOR SHALL MAINTAIN SUFFICIENT EQUIPMENT ON THE JOB SITE, TO PROVIDE DUST CONTROL AT ALL TIMES. AREAS SURROUNDING THE WORK SHALL BE KEPT CLEAN AND RETURNED TO ORIGINAL CONDITIONS UPON COMPLETION OF THIS CONTRACT.
- THE CONTRACTOR SHALL REPLACE ANY PAVEMENT DELINEATION OR TRAFFIC MARKINGS DAMAGED IN THE COURSE OF THIS WORK.
- ROCKSAW TRENCHING FOR IRRIGATION PIPES WILL BE PERMITTED.
- POWER TO PARKING LOT LIGHTING MUST BE TURNED OFF PRIOR TO TRENCHING. EXISTING ELECTRICAL CONDUIT FOR PARKING LOT LIGHTING MUST BE PROTECTED IN PLACE. LOCATION OF UNDERGROUND ELECTRICAL PARKING LOT LIGHTING IS APPROXIMATE AND MUST BE VERIFIED PRIOR TO TRENCHING FOR INSTALLATION OF IRRIGATION.

**ABBREVIATIONS:**

- L ANGLE
- AB AGGREGATE BASE
- AC ASPHALT CONCRETE
- AP ANGLE POINT
- BC BEGIN CURVE
- BEG BEGIN
- BSW BACK OF SIDEWALK
- C&G CURB AND GUTTER
- CC&S CURB, GUTTER AND SIDEWALK
- CO CLEANOUT
- CONC CONCRETE
- CONSTR CONSTRUCT
- CTV CABLE TV
- DI DROP INLET
- DRWY DRIVEWAY
- DWG DRAWING
- EC END CURVE
- EG EXISTING GRADE
- EJ EXPANSION JOINT
- ELELEV ELEVATION
- EP EDGE OF PAVEMENT
- EX EXISTING
- FC FACE OF CURB
- FG FINISHED GROUND
- FH FIRE HYDRANT
- FL FLOW LINE
- FM FORCE MAIN
- G GAS
- GB GRADE BREAK
- GFL GUTTER FLOW LINE
- GR GRATE
- GV GATE VALVE
- HP HIGH POINT
- HR HANDICAP RAMP
- INV INVERT
- IP IRON PIPE
- JP JOINT POLE
- L= LENGTH
- LF LINEAR FEET
- LI LEFT
- LP LOW POINT
- MH MANHOLE
- MP MIDPOINT
- OH OVERHEAD
- O.C. ON CENTER
- PB PULL BOX
- PCC POINT OF COMPOUND CURVE, PORTLAND CONCRETE CEMENT
- PI POINT OF INTERSECTION
- PP POWER POLE
- PS PLANTER STRIP
- PT POINT
- PUE PUBLIC UTILITY EASEMENT
- PWMT PAVEMENT
- R=R RADIUS
- RT RIGHT
- R/W RIGHT-OF-WAY
- SD STORM DRAIN
- SDMH STORM DRAIN MH
- SDW,SW SIDEWALK
- SECT SECTION
- SHT SHEET
- SS SANITARY SEWER
- SSMH SANITARY SEWER MH
- STD STANDARD
- STA STATION
- T TELEPHONE
- TBW TOP BACK OF WALK
- TC TOP OF CURB
- TYP TYPICAL
- UNO UNLESS NOTED OTHERWISE
- W,WTR WATER
- WV WATER VALVE

CITY OF FOLSOM  
COMMUNITY DEVELOPMENT DEPARTMENT

APPROVED BY: *[Signature]* 6-14-23  
CITY ENGINEER DATE

DEPARTMENT OF PUBLIC WORKS

APPROVED BY: *[Signature]* 6/13/23  
DIRECTOR DATE



NO.	REVISIONS	BY	DATE

BENCH MARK ELEV. : XX DATUM : XX  
DESCRIPTION :

DESIGN BY : JMINER  
DRAWN BY : JMINER  
CHECKED BY : L.RUBIO  
SCALE : N/A  
DATE : 06/12/23  
PROJ. NO. : 19303-03

VERIFY SCALE  
BAR IS ONE INCH ON ORIGINAL DRAWING  
IF NOT ONE INCH ON THIS SHEET, ADJUST SCALES ACCORDINGLY.



**BENNETT**  
TRUSTED ENGINEERING ADVISORS

Bennett Engineering Services  
1082 Sunrise Avenue, Suite 100  
Roseville, California 95661  
T 916.783.4100  
F 916.783.4110

FOLSOM - TRADERS LANE PARKING LOT

TITLE SHEET AND GENERAL NOTES

CITY OF FOLSOM

CALIFORNIA

T-1  
1 OF 4

Date Plotted: 06/13/23 11:00 AM  
 Plot Date: June 13, 2023 11:00 AM  
 User: jminer  
 Project: 19303-03-TRADERS LANE PARKING LOT  
 Sheet: T-1 OF 4

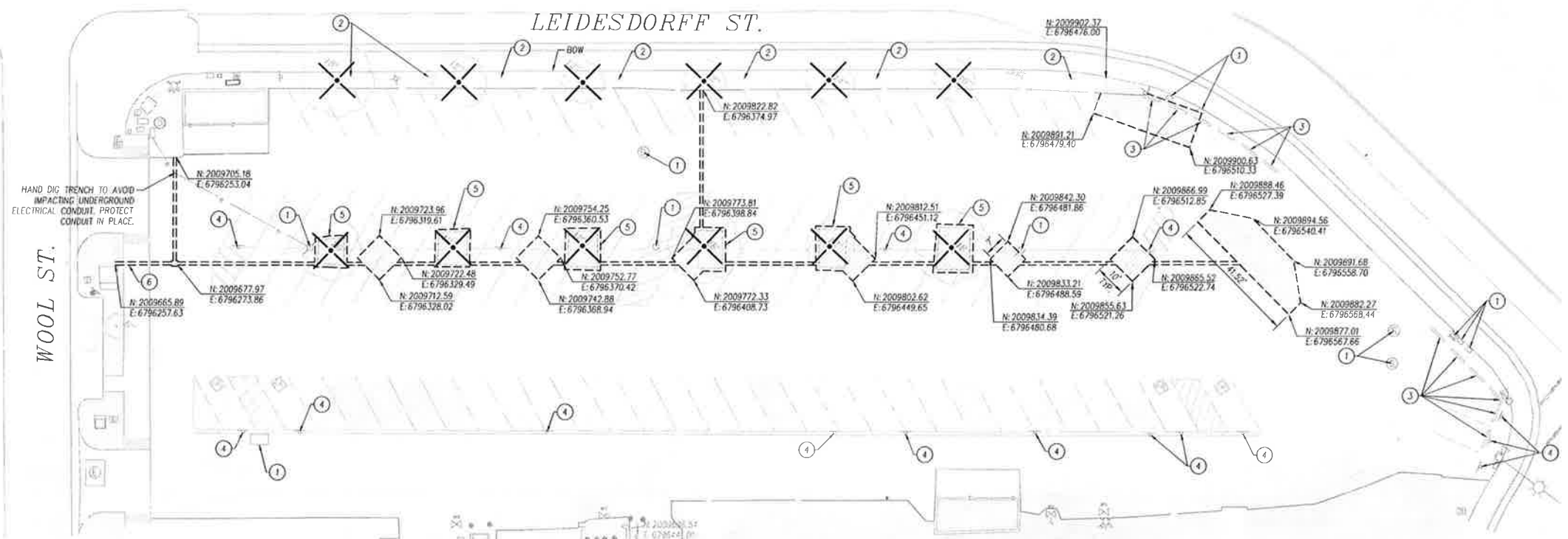

**DEMOLITION PLAN**  
SCALE: 1" = 20'

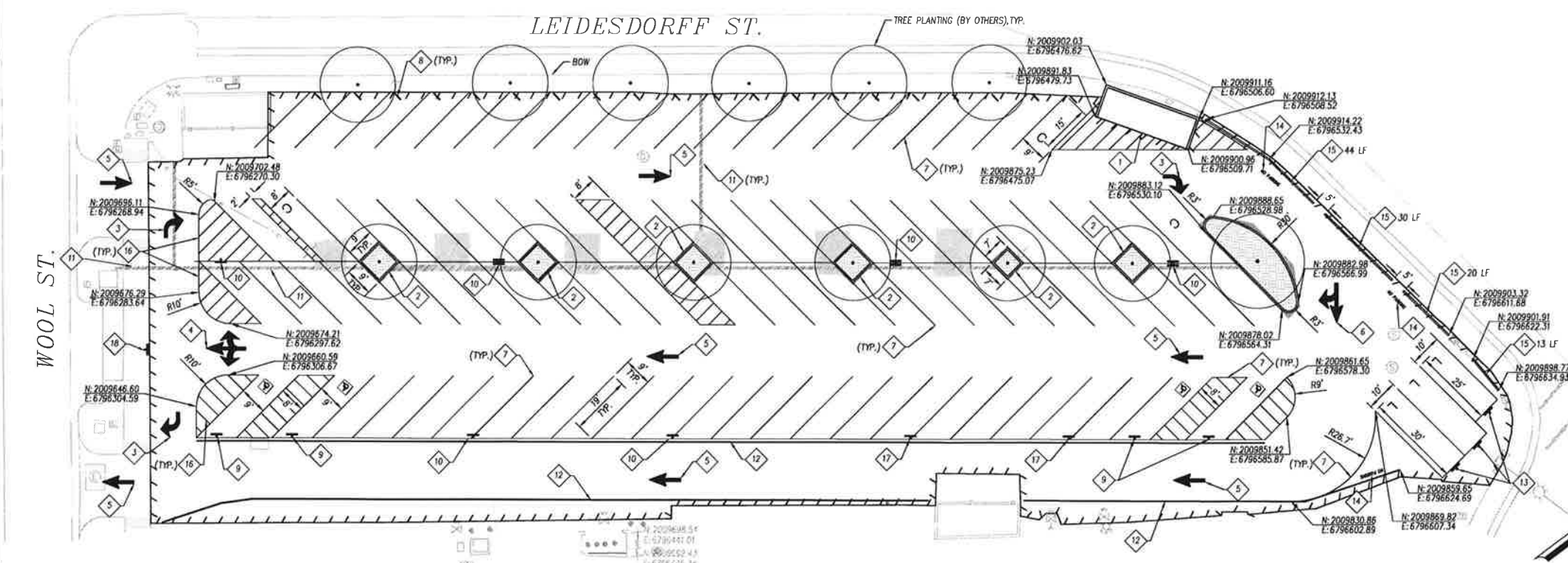

**LAYOUT PLAN**  
SCALE: 1" = 20'

- DEMOLITION NOTES:**
1. PROTECT UTILITY/STRUCTURE IN PLACE
  2. REMOVE AESTHETIC GRANITE
  3. REMOVE 6" WHEEL STOPS
  4. REMOVE AND SALVAGE SIGN
  5. RESTORE EXISTING TREE WELL. SEE DETAIL 6 ON SHEET CD-1
  6. SAWCUT CONCRETE SIDEWALK AND RESTORE AFTER IRRIGATION TRENCH INSTALLATION

- NOTES:**
1. CONTRACTOR TO PROTECT ALL UTILITIES IN PLACE, UNLESS OTHERWISE NOTED.
  2. UTILITY INFORMATION SHOWN IS APPROXIMATE BASED ON SOURCES OF VARYING RELIABILITY. CONTRACTOR SHALL POSITION/LOCATE ALL EXISTING FACILITIES PRIOR TO CONSTRUCTION.

- DEMOLITION LEGEND:**
- REMOVE HMA AND/OR TREE WELL
  - SAWCUT
  - REMOVE TREE, BY OTHERS

- CONSTRUCTION NOTES:**
1. INSTALL TRASH ENCLOSURE PER CITY OF FOLSOM STD DETAIL RD-24 SHEET CD-1
  2. INSTALL TREE WELL PER CITY OF FOLSOM DETAIL LS-07 AND DETAIL 1 SHEET CD-1
  3. INSTALL TYPE IV ARROW PAVEMENT MARKING, PER CALTRANS STD DETAIL A24A
  4. INSTALL TYPE VII ARROW PAVEMENT MARKING, PER CALTRANS STD DETAIL A24A
  5. INSTALL TYPE I ARROW PAVEMENT MARKING, PER CALTRANS STD DETAIL A24A
  6. INSTALL TYPE VI ARROW PAVEMENT MARKING, PER CALTRANS STD DETAIL A24A
  7. INSTALL 4" PARKING STRIPE
  8. INSTALL 3" WHEEL STOP
  9. INSTALL R99 (CA) SIGN AND POST.
  10. INSTALL CUSTOM SIGN AND POST, SIGN PER DETAIL 2 SHEET CD-1. SIGN POST IN MIDDLE OF PARKING LOT SHALL BE DOUBLE SIDED.
  11. IRRIGATION TRENCH PER DETAIL 3 SHEET CD-1
  12. INSTALL RED PAINT WITH WHITE "FIRE LANE" MARKINGS
  13. INSTALL COMMERCIAL SIGN AND POST, SIGN PER DETAIL 4 SHEET CD-1
  14. INSTALL "NO PARKING" WHITE MARKINGS
  15. INSTALL TYPE 4 CURB PER CITY OF FOLSOM DETAIL RD-01
  16. INSTALL 4" WIDE WHITE PAINT STRIPE AT 30' SPACED AT 3' O.C.
  17. INSTALL CUSTOM SIGN AND POST PER DETAIL 2 AND DETAIL 5 SHEET CD-1.
  18. INSTALL CUSTOM SIGN AND POST, SIGN PER DETAIL 7 SHEET CD-1.

- NOTES:**
1. TREES TO BE INSTALLED UNDER A DIFFERENT CONTRACT.
  2. SEE IRRIGATION PLAN FOR IRRIGATION WORK.

- CONSTRUCTION LEGEND:**
- TRASH ENCLOSURE CONCRETE PAD
  - TREE WELL
  - SEAL COAT
  - 3" HMA 12" AB
  - 8" HMA PLUG
  - IRRIGATION TRENCH



SCALE IN FEET

10/18/2023 10:07 AM  
 PROJECT: 19303-03 - 10/18/2023  
 DRAWING: 19303-03-01 - DEMOLITION AND LAYOUT PLAN  
 DESIGNER: JMINER  
 CHECKER: LRUBIO  
 DATE: 06/12/23

NO.	REVISIONS	BY	DATE

BENCH MARK ELEV.: XX	DATUM: XX
DESIGN BY: JMINER	CHECKED BY: LRUBIO
DATE: 06/12/23	PROJ. NO.: 19303-03

**VERIFY SCALE**  
 BAR IS ONE INCH ON ORIGINAL DRAWING.  
 SCALE: 1" = 20'  
 IF NOT ONE INCH ON THIS SHEET, ADJUST SCALES ACCORDINGLY.



**BENNETT ENGINEERING SERVICES**  
 1082 Sunrise Avenue, Suite 100  
 Roseville, California 95661  
 T 916.783.4100  
 F 916.783.4110



FOLSOM - TRADERS LANE PARKING LOT  
**DEMOLITION AND LAYOUT PLAN**  
 CALIFORNIA

LEIDESDORFF ST.

WOOL ST.

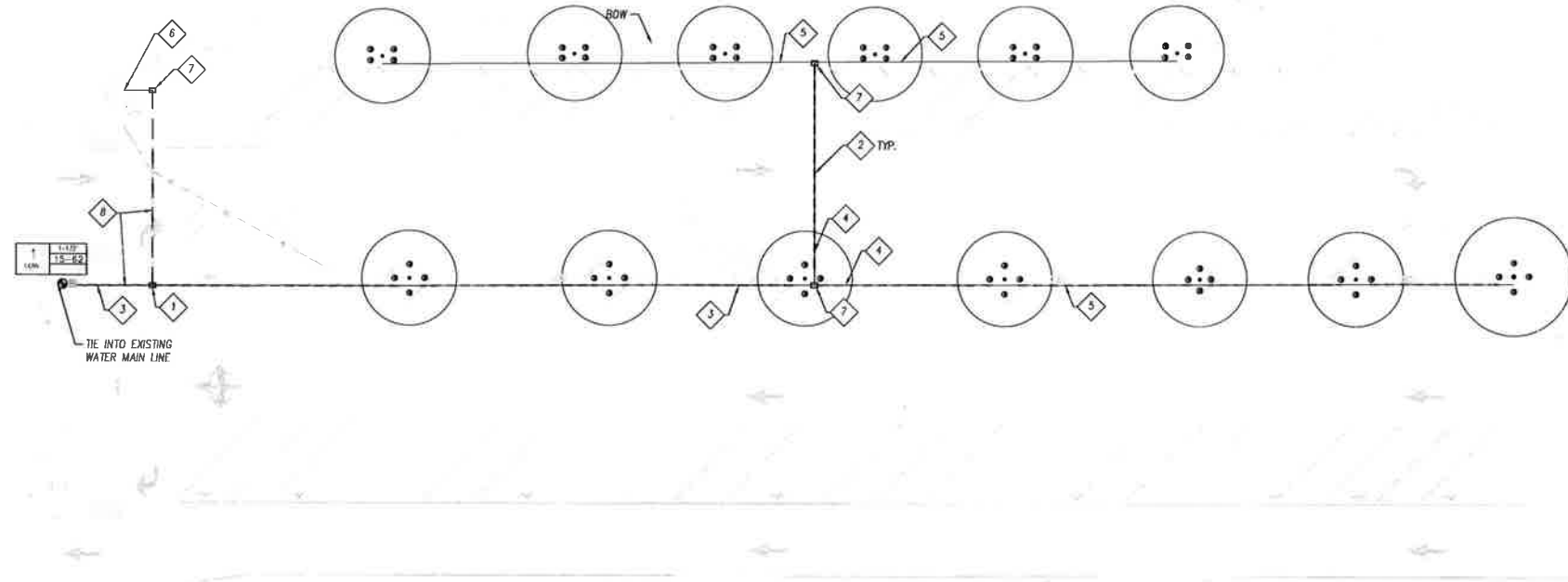

IRRIGATION NOTES:

- 1. INSTALL CHRISTY BOX PER CITY OF FOLSOM STANDARD DETAIL LS-31.
- 2. IRRIGATION TRENCH OVER SOIL PER CITY OF FOLSOM STANDARD DETAIL LS-20 AND UNDER ASPHALT PER DETAIL J, SHEET CD-1
- 3. INSTALL 1-1/2" IRRIGATION SCH40 PIPE
- 4. INSTALL 1-1/4" IRRIGATION SCH40 PIPE
- 5. INSTALL 1" IRRIGATION SCH40 PIPE
- 6. TIE IN TO EXISTING CONTROLLER
- 7. INSTALL CARSON 1419 VALVE BOX
- 8. INSTALL 14 AWG RED AND WHITE SOLID DIRECT BURY IRRIGATION WIRE IN 1-1/4" GREY CONDUIT

NOTES:

- 1. MAINLINE AND LATERAL UNDER ASPHALT SHALL BE SLEEVED WITH MINIMUM 2X DIAMETER SCH40 PIPE.
- 2. IRRIGATION WIRE SHALL HAVE 24" COVER.
- 3. MAINLINE FITTINGS SHALL BE ACCESSIBLE IN CONCRETE CHRISTY BOXES (90'S AND TEE'S). SLEEVES SHALL ENTER THE BOXES.
- 4. ALL TEES AND 90'S ON BRANCH AND LATERAL LINES TO SPRINKLERS SHALL BE SCH80 S x S.
- 5. CONNECT VALVE TO TERMINAL #1 ON CONTROLLER "A".
- 6. THE STATION WILL OPERATE AT APPROXIMATELY 30 GPM. 4 X 0.25 GPM STREAM BUBBLERS PER TREE. BUBBLERS SHALL BE HUNTER PROS-06-PRS30-CV (R).
- 7. TEFLON TAPE SHALL BE USED ON ALL THREADED FITTINGS.

IRRIGATION SCHEDULE

SYMBOL	MANUFACTURER/MODEL/DESCRIPTION	QTY	PSI
⊙	HUNTER PROS-PRS30-06-CV WITH HUNTER MSEN-25q NOZZLES, PROVIDE 4 PER TREE.	52	
■	RAIN BIRD KCZ-150-1CS (15-62GPM) DRIP CONTROL KIT.	1	
●	AQUALINE 1", 1-1/2", 1-1/4" FULL PORT BRASS BALL VALVE.	1	
—	IRRIGATION LATERAL LINE: PVC SCHEDULE 40	1" = 332 L.F. 1-1/4" = 103 L.F. 1-1/2" = 187 L.F.	
—	PIPE SLEEVE: PVC SCHEDULE 40	407 L.F.	
---	IRRIGATION WIRE: 14 AWG RED AND WHITE SOLID DIRECT BURY	76 L.F.	



Plot Date: June 12, 2023 - 1:10 PM  
 User: jminer  
 Path: \\server\projects\193303-03\193303-03\193303-03.dwg  
 Title: IRRIGATION PLAN  
 Author: JMINER  
 Date: 06/12/23  
 Project: 193303-03

NO.	REVISIONS	BY	DATE

BENCH MARK	ELEV. : XX	DATUM : XX
DESCRIPTION		

DESIGN BY :	J.MINER
DRAWN BY :	J.MINER
CHECKED BY :	L.RUBIO
SCALE :	1"=20'
DATE :	06/12/23
PROJ NO. :	193303-03

VERIFY SCALE  
 BAR IS ONE INCH ON ORIGINAL DRAWING.  
 IF NOT ONE INCH ON THIS SHEET, ADJUST SCALES ACCORDINGLY.



**BEN EN**  
 TRUSTED ENGINEERING ADVISORS

Bennett Engineering Services  
 1082 Sunrise Avenue, Suite 100  
 Roseville, California 95661  
 T 916.783.4100  
 F 916.783.4110

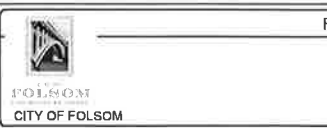

FOLSOM - TRADERS LANE PARKING LOT

IRRIGATION PLAN

CALIFORNIA

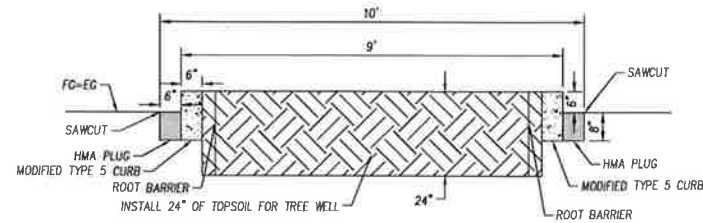

1 TREE WELL DETAIL  
DM-1 NTS

COMMERCIAL VEHICLE  
LOADING/UNLOADING  
IN MARKED SPACES ONLY  
NOT TO EXCEED  
20 MINUTES  
FMC 10.20.10

4 COMMERCIAL SIGN DETAIL  
DM-1 NTS

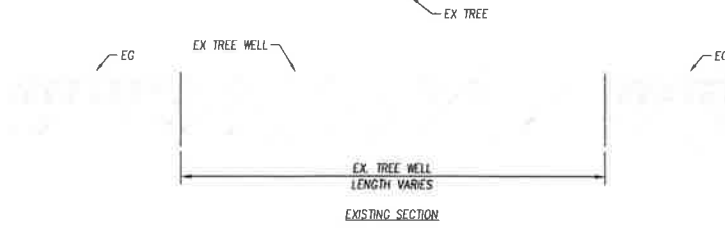

6 TREE WELL RESTORATION  
DM-1 NTS

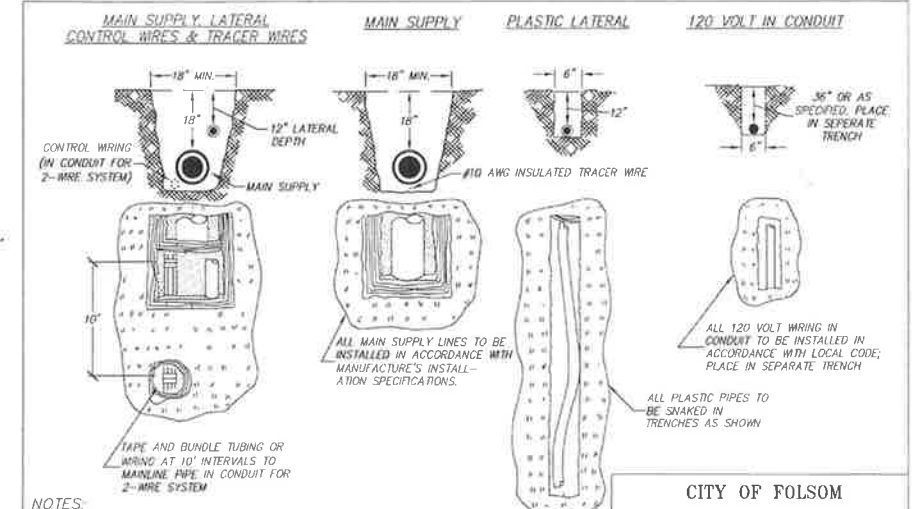

NOTES:

1. ALL TRENCH BACKFILL SHALL BE COMPACTED TO A MINIMUM OF 90% RELATIVE COMPACTION.
2. MINIMUM DEPTH OF PIPE/SLEEVE/CONDUIT UNDERNEATH PAVEMENT SHALL BE 24\"/>

CITY OF FOLSOM	
IRRIGATION SYSTEM TRENCHING	
SCALE: NONE	LS-20
DATE: FEBRUARY 2020	



NOTES:  
1. CUSTOM SIGN TEXT SHALL MATCH EXISTING SIGN.

2 CUSTOM SIGN DETAIL  
DM-1 NTS

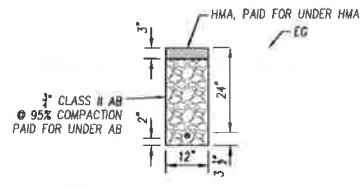

NOTES:  
1. ROCKSAW TRENCHING IS ALLOWED, EXCEPT OVER EXISTING ELECTRICAL CONDUIT

3 TRENCH DETAIL  
DM-1 NTS



5 CUSTOM NO PARKING SIGNS DETAIL  
DM-1 NTS



7 CUSTOM SIGN DETAIL  
DM-1 NTS

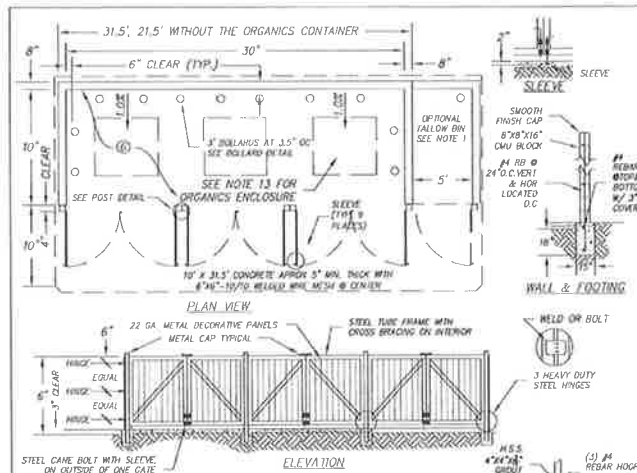

NOTE:

1. GREASE/TALLOW BIN ENCLOSURE MAY BE ATTACHED TO THE TRASH ENCLOSURE OR BE CONSTRUCTED SEPARATELY. THE GREASE/TALLOW BIN SHALL NOT BE LOCATED WITHIN THE TRASH/RECYCLING ENCLOSURE.
2. ENCLOSURE SHALL BE ORIENTED AND MAINTAINED TO BE UNOBSTRUCTED 26\"/>

CITY OF FOLSOM	
TRASH, RECYCLING, & ORGANICS ENCLOSURE	
SCALE: NONE	RD-24
DATE: APRIL 2021	

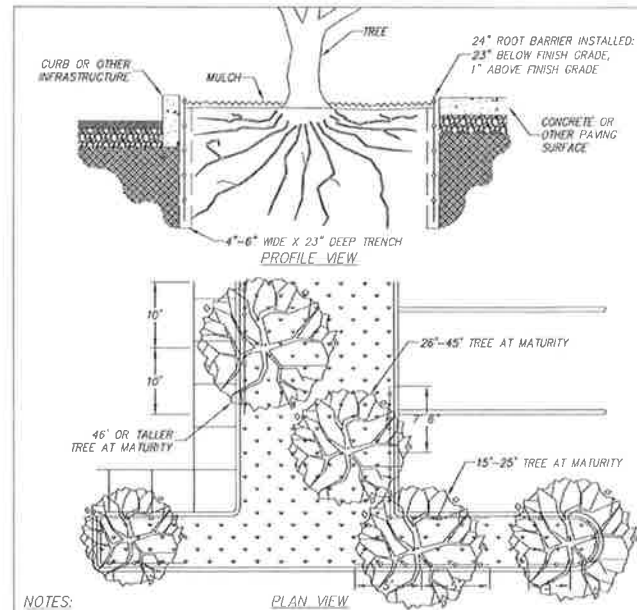

NOTES:

1. CITY OF FOLSOM APPROVED TREE ROOT BARRIERS SHALL BE 16 MESH (0.11 INCH DIAMETER) COPPER MESH.
2. BARRIER SHALL BE ALL 4 SIDES OF TREE WELL.

CITY OF FOLSOM	
TREE ROOT BARRIER	
SCALE: NONE	LS-07
DATE: FEBRUARY 2020	

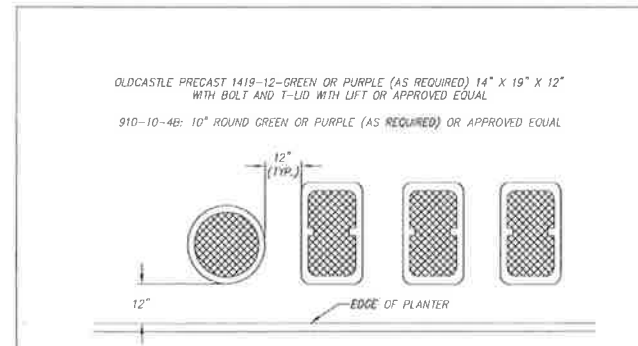

NOTE:

1. QUICK COUPLING VALVE SHALL BE PLACED IN ROUND VALVE BOX WITH LOCKING BOLT.
2. REMOTE CONTROL VALVE ASSEMBLY SHALL BE PLACED IN RECTANGULAR VALVE BOX WITH LOCKING BOLT.
3. PLACE REMOTE CONTROL VALVE ASSEMBLY IN SHRUB/GROUNDCOVER AREA WHENEVER POSSIBLE.
4. SET VALVE BOXES PARALLEL TO EACH OTHER AND PERPENDICULAR TO EDGE OF PLANTER.
5. SET ALL GROUPING OF VALVE BOXES AT SAME LEVEL ABOVE GROUND.
6. ALL VALVE BOXES SHALL HAVE A MINIMUM CLEARANCE OF 6\"/>

CITY OF FOLSOM	
VALVE BOX LAYOUT	
SCALE: NONE	LS-31
DATE: FEBRUARY 2020	

User: jminer (19303-03) - 1:04 PM  
 Plot Date: June 12, 2020  
 Plot Path: \\s01\proj\19303-03\19303-03-10-01-01-01.dwg  
 Plot Scale: 1/8"=1'-0"  
 Plot Size: 11.00 x 17.00

NO.	REVISIONS	BY	DATE

BENCH MARK	ELEV.	XX	DATUM	XX
DESCRIPTION:				

DESIGN BY:	JMINER
DRAWN BY:	JMINER
CHECKED BY:	L.RUBIO
SCALE:	N/A
DATE:	06/12/23
PROJ NO.:	19303-03

VERIFY SCALE  
 BAR IS ONE INCH ON ORIGINAL DRAWING.  
 IF NOT ONE INCH ON THIS SHEET, ADJUST SCALES ACCORDINGLY.



**BEN EN**  
 TRUSTED ENGINEERING ADVISORS  
 Bennett Engineering Services  
 1082 Sunrise Avenue, Suite 100  
 Roseville, California 95661  
 T 916.783.4100  
 F 916.783.4110

FOLSOM - TRADERS LANE PARKING LOT	
CONSTRUCTION DETAILS	
SCALE: NONE	LS-31
DATE: FEBRUARY 2020	
CITY OF FOLSOM	
CALIFORNIA	

CD-1  
 4  
 OF  
 4